

BORA Professional 3.0

Planning documents

BORA Professional 3.0 Highlights

Intuitive control knob

The combination of a classic knob and a touch-operated surface with a razor-sharp LED display enables perfect control. All functions are easily, conveniently and intuitively activated by twisting the knob and tapping the central touch-operated surface.

Premium design

Pioneering design language meets the highest standards with regard to materials and technology. The design highlights are the extractor and the sleek control knob with its stainless steel ring, black glass front and clear, white LED display.

Simple cleaning

All parts that come into contact with cooking vapours can be easily removed through the accessible, wide inlet opening. They can then be cleaned in the dishwasher, where they take up very little space.

Oversized surface induction cooking zones

Particularly large surface induction cooking zones enable you to consistently warm even very large pots or roasters through.

Automatic extractor control

The extractor power level automatically adjusts itself according to current cooking conditions. There's no need for constant manual adjustment, which means you can focus fully on your cooking.

Automatic cover flap

The cover flap opens and closes automatically when the extractor is used. The integrated sensor technology reliably prevents items from getting trapped during closure. When switched off, the elegant system is fully closed.

Minimum volume

Always markedly quiet - even at high power levels: The reason lies in the optimal airflow and the use of an extremely low-noise fan. There are no distractions when cooking and no interruptions when entertaining.

Oversized 4 24 cooking surface

With extra-deep 54cm cooktops, BORA Professional gives you even more room to cook. Even 2 large pots can be easily placed one behind the other.

Modular system

BORA offers a wide range of cooktops, from surface induction to gas cooktops or Tepan stainless steel grills, which can be freely combined with the extraction system. Combinations with one, three or more cooktops are also easily achievable.

Accurate temperature control

The Tepan stainless steel grill offers top performance, 2 large grill areas and unique, precise temperature control. The required temperature can be set directly and is accurately displayed and maintained. Rapid heating to 250°C in under 5 minutes saves time and energy.

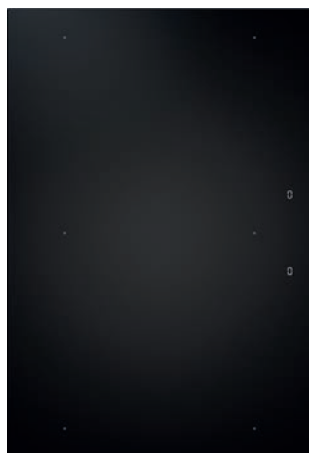

PKFI3

BORA Pro surface induction cooktop

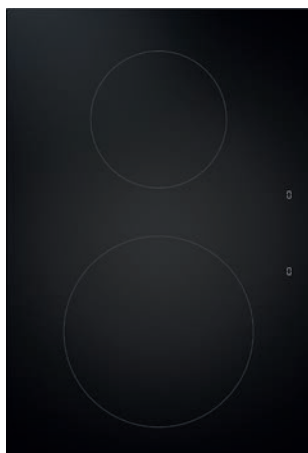

PKI3

BORA Pro induction cooktop

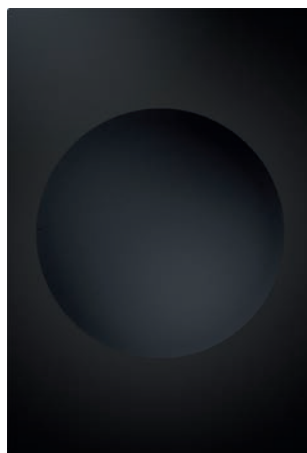

PKIW3

BORA Pro induction wok cooktop

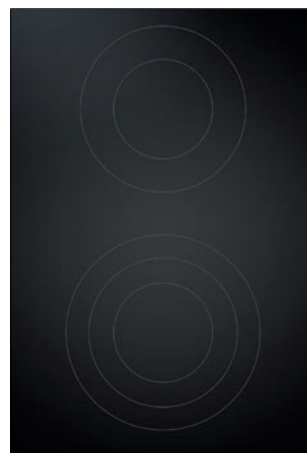

PKC3

BORA Pro HiLight cooktop 3-ring/2-ring



PKCB3

BORA Pro HiLight cooktop 3 ring/roaster

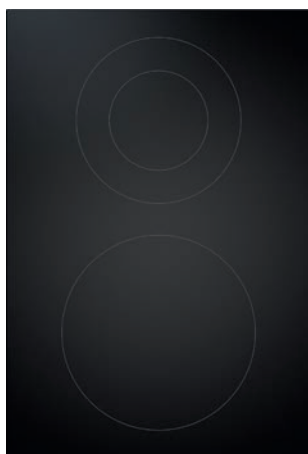

PKCH3

BORA Pro Hyper cooktop 1-ring/2-ring

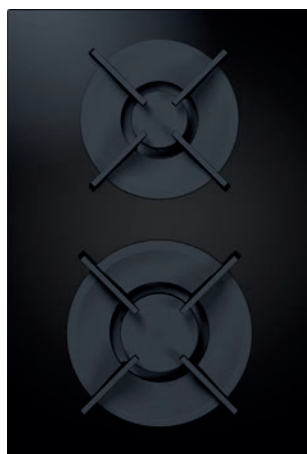

PKG3

BORA Pro gas cooktop



PKT3

BORA Pro Tepan stainless steel grill



PKA3

BORA Pro cooktop extractor



Control knob
BORA Pro 3.0



PKA3AB

BORA Pro cooktop extractor All Black



Control knob
BORA Pro 3.0 All Black

PKAS3

BORA Pro cooktop extractor system with integrated fan

PKAS3AB

BORA Pro Cooktop Extractor System with Integrated Fan All Black

BORA Professional 3.0 sets

BORA Professional 3.0 cooktops as a set combination

Components:

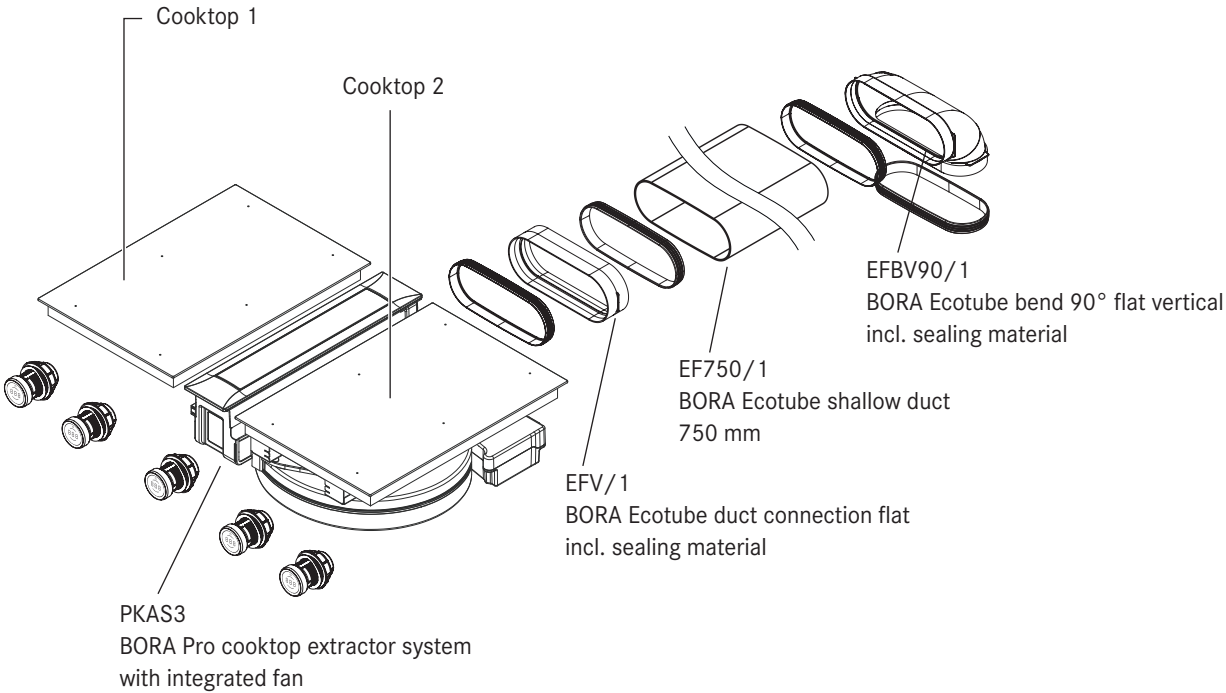

PKAS3FI

BORA Pro Set surface induction

(1x PKAS3, 2x PKFI3, 1x EFBV90, 1x EF750, 1x EFV)



PKAS3FIAB

BORA Pro Set All Black

(1x PKAS3AB, 2x PKFI3, 1x EFBV90, 1x EF750, 1x EFV)



PKAS3FIT

BORA Pro Set surface induction Tepan

(1x PKAS3, 1x PKFI3, 1x PKT3, 1x EFBV90, 1x EF750, 1x EFV)



PKAS3HL

BORA Pro set HiLight

(1x PKAS3, 1x PKC3, 1x PKCB3, 1x EFBV90, 1x EF750, 1x EFV)

PKA3

BORA Pro cooktop extractor

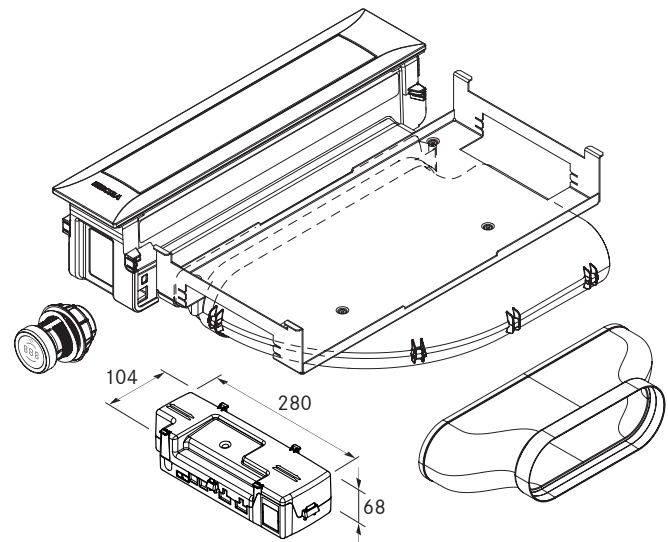
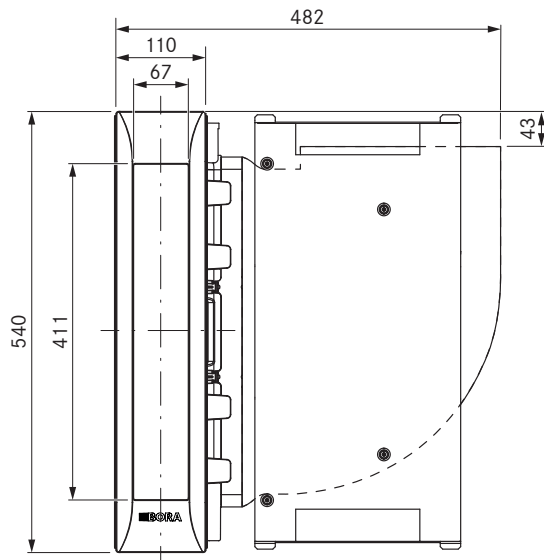
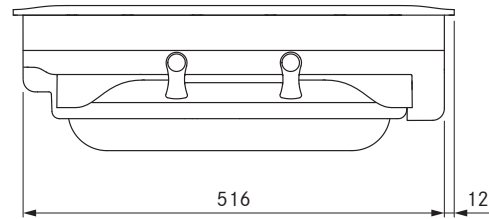
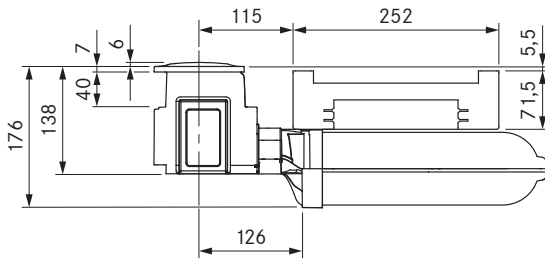

technical data

| | |
|--------------------------------------|--------------------|
| Supply voltage | 220 – 240 V |
| Frequency | 50/60 Hz |
| Maximum power consumption | 550 W |
| Power supply cable length | 2 m |
| Dimensions (width x depth x height) | 482 x 540 x 176 mm |
| Weight (incl. accessories/packaging) | 9.25 kg |
| Cooktop extractor power levels | 1 – 9, P |
| duct connection | BORA Ecotube |

Product description

- Intuitive control knob
- Automatic cover flap
- Premium design
- Minimum volume
- Simple cleaning
- Integrated grease drip pan
- Genuine stainless steel grease filter
- Modular system
- Automatic extractor control
- Demo mode

Scope of delivery

- Cooktop extractor PKA3 with integrated 90° bend
- Straight duct element
- Control knob
- cover flap
- stainless steel grease filter
- Filter tray
- Maintenance tray
- CAT 5 communication cable
- Universal control unit
- connection cable for the control knob
- operating and installation instructions
- height adjustment plate set
- Mounting clamps
- Power supply cable with type E + F plugs
- Ecotube seal flat EFD

Accessories

- PKA1FF stainless steel grease filter
- PKA1VK cover flap
- PKA1FW filter tray
- UNLI type I power supply cable (AUS)
- UNLJ type J power supply cable (CH)
- UNLG type G power supply cable (GB-IE)
- UNLB type B power supply cable (PH)
- UNLH type H power supply cable (IL)

product- and planning instructions

- Suitable for use as a recirculation or exhaust system
- Compatible with all BORA Professional 3.0 cooktops and BORA Universal fan modules
- Use of an additional fan module is possible for very long or complex exhaust air channels
- The worktop height can be adjusted as necessary
- Worktop depth: ≥ 700 mm (in conjunction with the straight duct element ≥ 650 mm)
- Airflow possible to the right or left
- Fan can be positioned in the plinth area as a result of the low installation height (100 mm) (when using the ULS plinth fan only)
- Installation type: flush or surface-mounted
- Universal control unit as central connection point can be simply and compactly positioned in the plinth area
- The extractor and Universal control unit are connected by a CAT 5 communication cable
- The drawers and/or shelves in the floor unit must be removable for maintenance and cleaning purposes
- The BORA Ecotube duct system is optimally tailored to the BORA cooktop extractors and guarantees 100% functionality and optimum performance
- The Professional cooktop extractor system can be combined with all BORA sockets

PKA3AB

BORA Pro cooktop extractor All Black

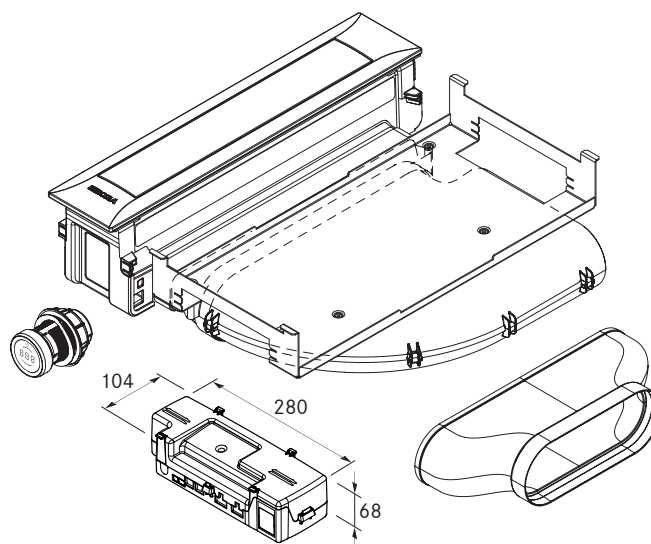
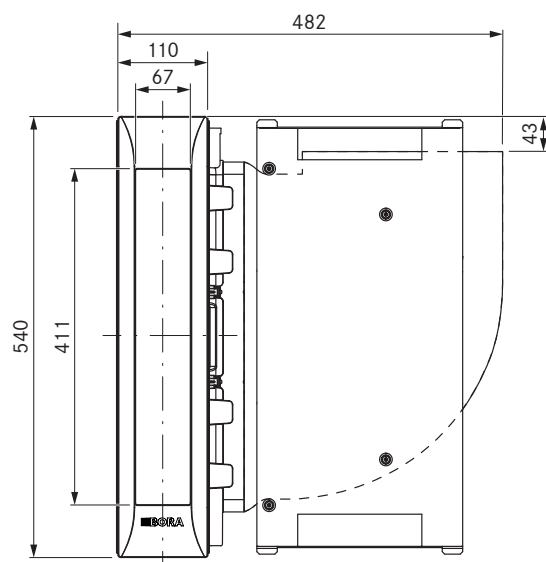
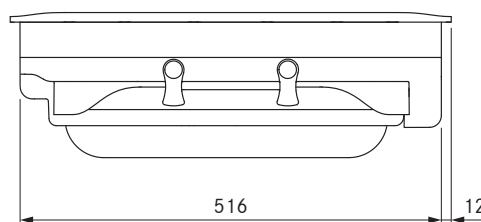
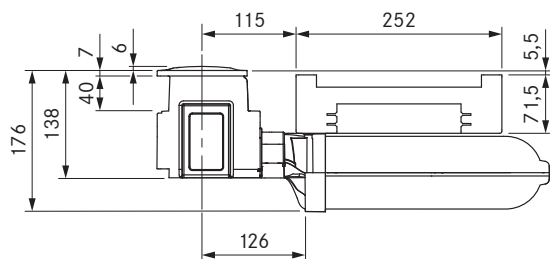

technical data

| | |
|--------------------------------------|--------------------|
| Supply voltage | 220 – 240 V |
| Frequency | 50/60 Hz |
| Maximum power consumption | 550 W |
| Power supply cable length | 2 m |
| Dimensions (width x depth x height) | 482 x 540 x 176 mm |
| Weight (incl. accessories/packaging) | 9.25 kg |
| Cooktop extractor power levels | 1 – 9, P |
| duct connection | BORA Ecotube |

Product description

- Intuitive control knob
- DLC (diamond-like-carbon) coated
- Automatic cover flap
- Premium design
- Minimum volume
- Simple cleaning
- Integrated grease drip pan
- Genuine stainless steel grease filter
- Modular system
- Automatic extractor control

Scope of delivery

- Cooktop extractor PKA3AB with integrated 90° bend
- Straight duct element
- Control knob
- 4 x Pro knob ring All Black PKR3AB
- cover flap
- stainless steel grease filter
- Filter tray
- Maintenance tray
- CAT 5 communication cable
- Universal control unit
- connection cable for the control knob
- operating and installation instructions
- height adjustment plate set
- Mounting clamps
- Power supply cable with type E + F plugs
- Ecotube seal flat EFD

Accessories

- PKA1FF stainless steel grease filter
- PKA1VKAB cover flap
- PKA1FW filter tray
- UNLI type I power supply cable (AUS)
- UNLJ type J power supply cable (CH)
- UNLG type G power supply cable (GB-IE)
- UNLB type B power supply cable (PH)
- UNLH type H power supply cable (IL)

product- and planning instructions

- Suitable for use as a recirculation or exhaust system
- Compatible with all BORA Professional 3.0 cooktops and BORA Universal fan modules
- In addition, four knob ring All Black are included for the adjacent cooktops
- Use of an additional fan module is possible for very long or complex exhaust air channels
- The worktop height can be adjusted as necessary
- Worktop depth: ≥ 700 mm (in conjunction with the straight duct element ≥ 650 mm)
- Airflow possible to the right or left
- Fan can be positioned in the plinth area as a result of the low installation height (100 mm) (when using the ULS plinth fan only)
- Installation type: flush or surface-mounted
- Universal control unit as central connection point can be simply and compactly positioned in the plinth area
- The extractor and Universal control unit are connected by a CAT 5 communication cable
- The drawers and/or shelves in the floor unit must be removable for maintenance and cleaning purposes
- The BORA Ecotube duct system is optimally tailored to the BORA cooktop extractors and guarantees 100% functionality and optimum performance
- The Professional cooktop extractor system can be combined with all BORA sockets

PKAS3

BORA Pro cooktop extractor system with integrated fan

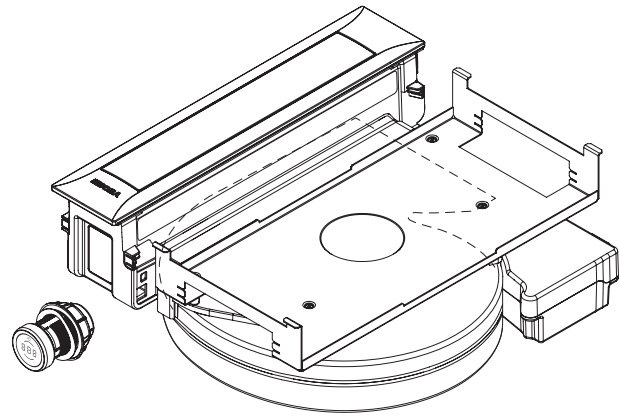
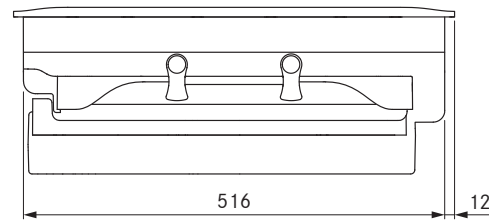
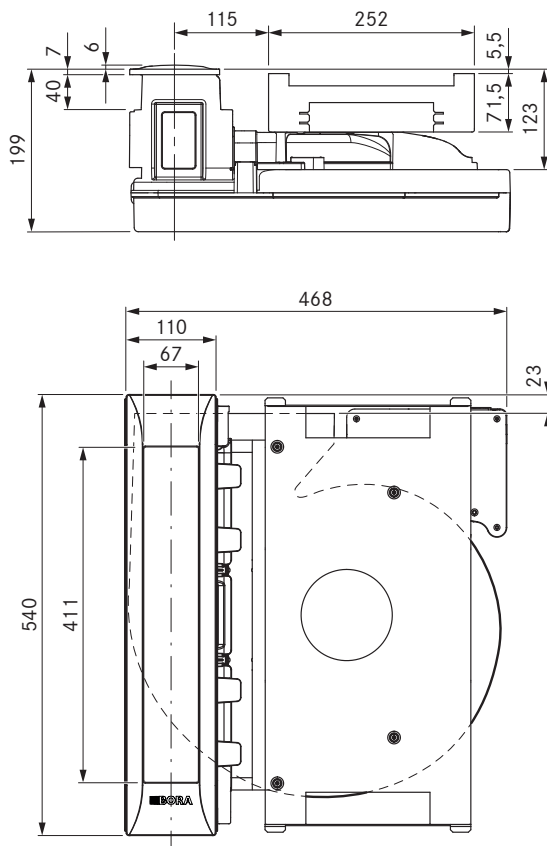

technical data

| | |
|--------------------------------------|--------------------|
| Supply voltage | 220 – 240 V |
| Frequency | 50/60 Hz |
| Maximum power consumption | 550 W |
| Power supply cable length | 2 m |
| Dimensions (width x depth x height) | 468 x 540 x 199 mm |
| Weight (incl. accessories/packaging) | 12.5 kg |
| Cooktop extractor power levels | 1 – 9, P |
| duct connection | BORA Ecotube |

Product description

- Intuitive control knob
- Automatic cover flap
- Premium design
- Simple cleaning
- Integrated grease drip pan
- Genuine stainless steel grease filter
- Modular system
- Automatic extractor control
- Maximum storage space
- Integrated fan

Scope of delivery

- Cooktop extractor system with integrated fan PKAS3
- Control knob
- stainless steel grease filter
- Filter tray
- Maintenance tray
- cover flap
- connection cable for the control knob
- operating and installation instructions
- height adjustment plate set
- Mounting clamps
- Power supply cable with type E + F plugs

Accessories

- PKA1FF stainless steel grease filter
- PKA1VK cover flap
- PKA1FW filter tray
- UNLI type I power supply cable (AUS)
- UNLJ type J power supply cable (CH)
- UNLG type G power supply cable (GB-IE)
- UNLB type B power supply cable (PH)
- UNLH type H power supply cable (IL)

product- and planning instructions

- Suitable for use as a recirculation or exhaust system
- Compatible with all BORA Professional 3.0 cooktops and BORA Universal fan modules
- Use of an additional fan module is possible for very long or complex exhaust air channels
- The worktop height can be adjusted as necessary
- Worktop depth: ≥ 700 mm
- Installation type: flush or surface-mounted
- The drawers and/or shelves in the floor unit must be removable for maintenance and cleaning purposes
- The BORA Ecotube duct system is optimally tailored to the BORA cooktop extractors and guarantees 100% functionality and optimum performance
- The Professional cooktop extractor system can be combined with all BORA sockets
- Duct connection on the back of the appliance

PKAS3AB

BORA Pro Cooktop Extractor System with Integrated Fan All Black

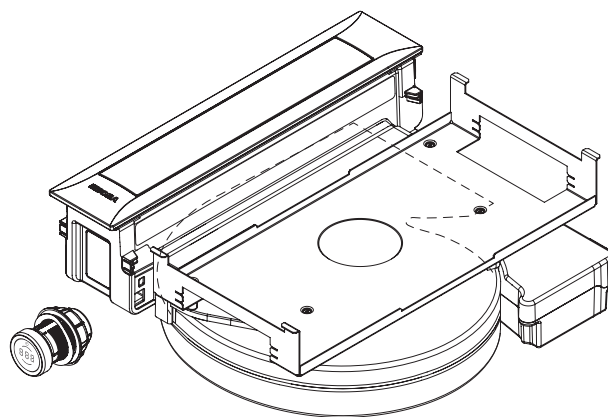
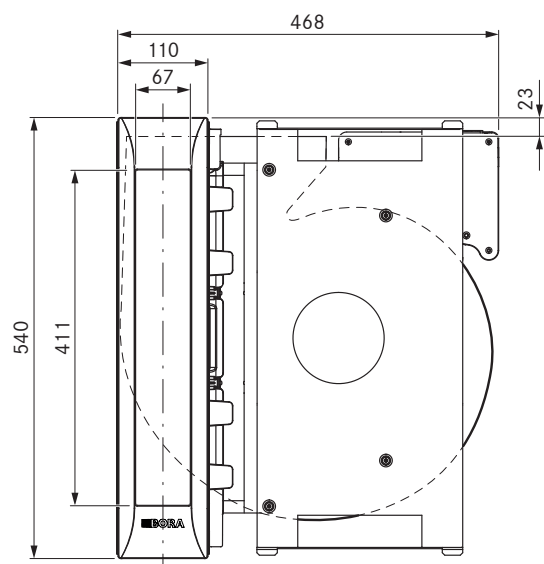
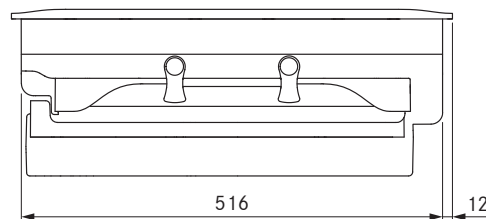
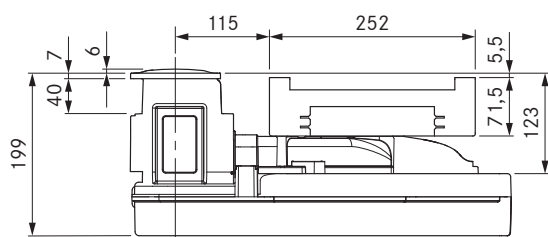

technical data

| | |
|--------------------------------------|--------------------|
| Supply voltage | 220 – 240 V |
| Frequency | 50/60 Hz |
| Maximum power consumption | 550 W |
| Power supply cable length | 2 m |
| Dimensions (width x depth x height) | 468 x 540 x 199 mm |
| Weight (incl. accessories/packaging) | 12.5 kg |
| Cooktop extractor power levels | 1 – 9, P |
| duct connection | BORA Ecotube |

Product description

- Intuitive control knob
- DLC (diamond-like-carbon) coated
- Automatic cover flap
- Premium design
- Simple cleaning
- Integrated grease drip pan
- Modular system
- Automatic extractor control
- Maximum storage space
- Integrated fan

Scope of delivery

- Cooktop extractor system with integrated fan PKAS3AB
- Control knob
- 4 x Pro knob ring All Black PKR3AB
- stainless steel grease filter
- Filter tray
- Maintenance tray
- cover flap
- connection cable for the control knob
- operating and installation instructions
- height adjustment plate set
- Mounting clamps
- Power supply cable with type E + F plugs

Accessories

- PKA1FF stainless steel grease filter
- PKA1VK cover flap
- PKA1FW filter tray
- UNLI type I power supply cable (AUS)
- UNLJ type J power supply cable (CH)
- UNLG type G power supply cable (GB-IE)
- UNLB type B power supply cable (PH)
- UNLH type H power supply cable (IL)

product- and planning instructions

- Suitable for use as a recirculation or exhaust system
- Compatible with all BORA Professional 3.0 cooktops and BORA Universal fan modules
- In addition, four knob ring All Black are included for the adjacent cooktops
- Use of an additional fan module is possible for very long or complex exhaust air channels
- The worktop height can be adjusted as necessary
- Worktop depth: ≥ 700 mm
- Installation type: flush or surface-mounted
- The drawers and/or shelves in the floor unit must be removable for maintenance and cleaning purposes
- The BORA Ecotube duct system is optimally tailored to the BORA cooktop extractors and guarantees 100% functionality and optimum performance
- The Professional cooktop extractor system can be combined with all BORA sockets
- Duct connection on the back of the appliance

PKFI3

BORA Pro surface induction cooktop

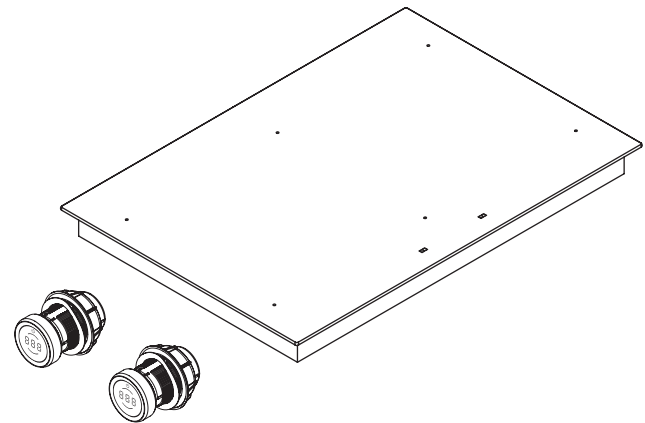
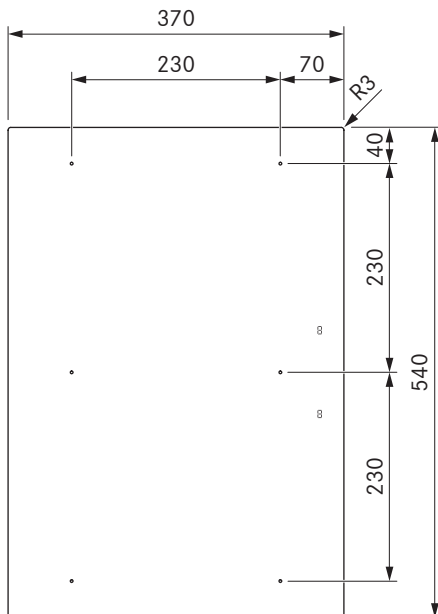
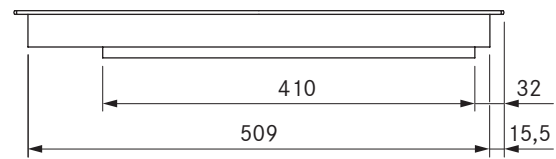
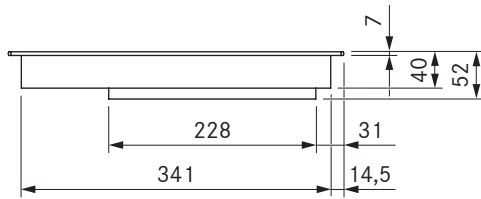

technical data

| | |
|---|-------------------|
| Supply voltage | 220 – 240 V |
| Frequency | 50/60 Hz |
| Maximum power consumption | 3.68 kW |
| Maximum power rating | 3.68 kW |
| Minimum fuse protection | 1 x 16 A |
| Power supply cable length | 1,5 m |
| Dimensions (width x depth x height) | 370 x 540 x 52 mm |
| Weight (incl. accessories/packaging) | 8.1 kg |
| Surface material | SCHOTT CERAN® |
| Cooktop power levels | 1 – 9, P |
| Size of front cooking zone | 230 x 230 mm |
| Size of rear cooking zone | 230 x 230 mm |
| Front cooking zone output | 2100 W |
| Rear cooking zone output | 2100 W |
| Front cooking zone power setting output | 3680 W |
| Rear cooking zone power setting output | 3680 W |

Product description

- Intuitive control knob
- Oversized surface induction cooking zones
- Performance level display on the cooktop
- Variable heat retention function
- bridging function
- childproofing feature
- Cooking zone timers
- Timer
- Demo mode
- Pause function

Scope of delivery

- Surface induction cooktop PKFI3
- 2 x control knobs
- 2 x connection cables for the control knobs
- Connection cable to the extractor
- operating and installation instructions
- mounting straps
- height adjustment plate set

product- and planning instructions

- Rotation by 180° possible during installation
- Please note that induction-compatible cookware must be used on induction cooktops
- Ensure sufficient ventilation of the area below the cooktop.

BORA Pro induction cooktop

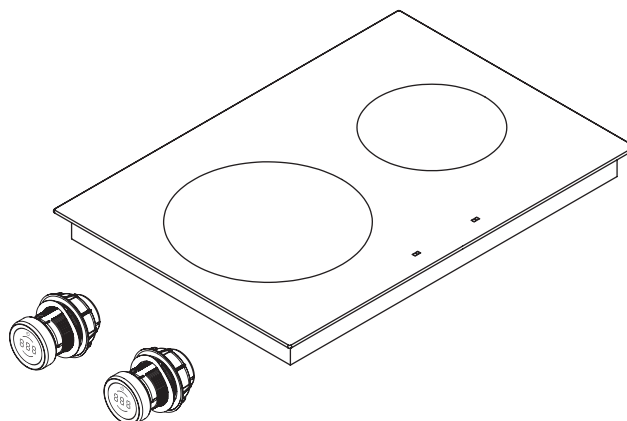
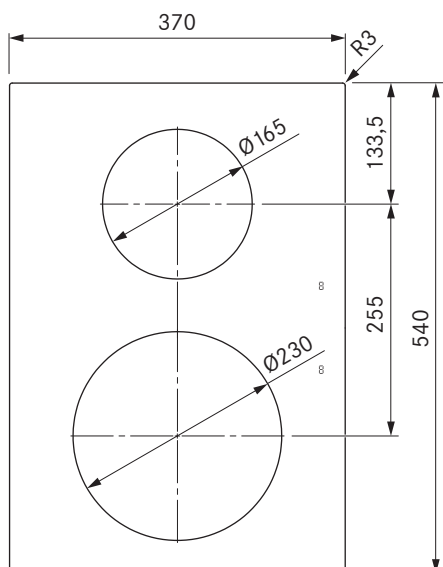
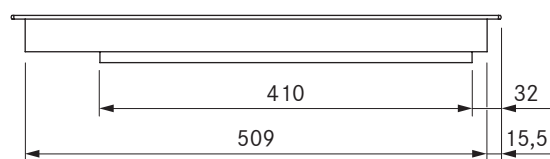

| | |
|---|-------------------|
| Supply voltage | 220 – 240 V |
| Frequency | 50/60 Hz |
| Maximum power consumption | 3.68 kW |
| Maximum power rating | 3.68 kW |
| Minimum fuse protection | 1 x 16 A |
| Power supply cable length | 1,5 m |
| Dimensions (width x depth x height) | 370 x 540 x 52 mm |
| Weight (incl. accessories /packaging) | 8.0 kg |
| Surface material | SCHOTT CERAN® |
| Cooktop power levels | 1 – 9, P |
| Size of front cooking zone | Ø 230 mm |
| Size of rear cooking zone | Ø 165 mm |
| Front cooking zone output | 2300 W |
| Rear cooking zone output | 1400 W |
| Front cooking zone power setting output | 3680 W |
| Rear cooking zone power setting output | 2200 W |

- Intuitive control knob
- Performance level display on the cooktop
- Variable heat retention function
- childproofing feature
- Cooking zone timers
- Timer
- Pause function
- automatic heat up function
- pan size recognition
- Demo mode

- Induction cooktop PKI3
- 2 x control knobs
- 2 x connection cables for the control knobs
- Connection cable to the extractor
- operating and installation instructions
- mounting straps
- height adjustment plate set

- Rotation by 180° possible during installation
- Please note that induction-compatible cookware must be used on induction cooktops
- Ensure sufficient ventilation of the area below the cooktop.

PKIW3

BORA Pro induction wok cooktop

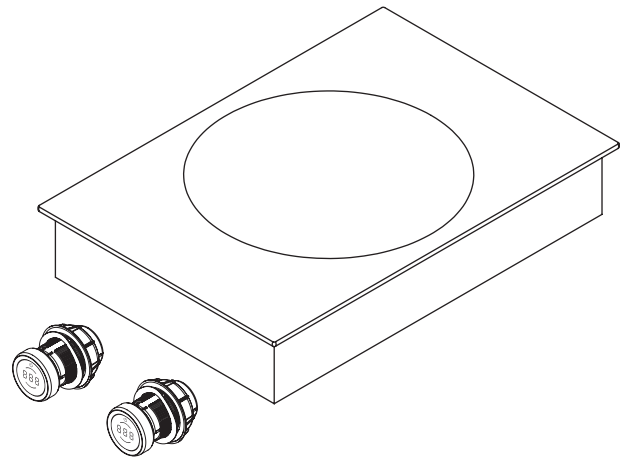
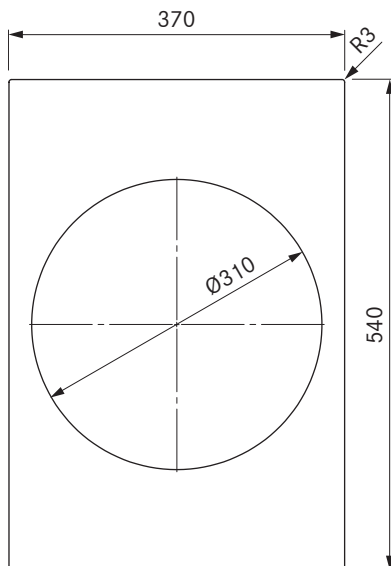
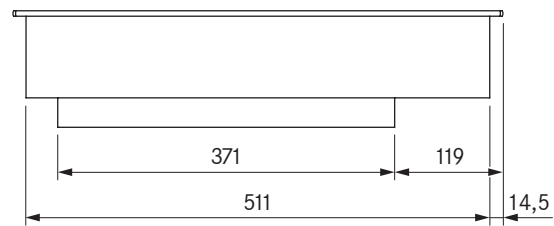
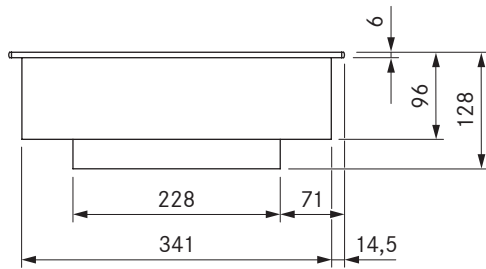

technical data

| | |
|--------------------------------------|--------------------|
| Supply voltage | 220 – 240 V |
| Frequency | 50/60 Hz |
| Maximum power consumption | 3.0 kW |
| Maximum power rating | 3.0 kW |
| Minimum fuse protection | 1 x 16 A |
| Power supply cable length | 1,5 m |
| Dimensions (width x depth x height) | 370 x 540 x 128 mm |
| Weight (incl. accessories/packaging) | 9.5 kg |
| Surface material | SCHOTT CERAN® |
| Cooktop power levels | 1 – 9, P |
| Size of cooking zone | Ø 310 mm |
| Cooking zone output | 2400 W |
| Cooking zone power setting output | 3000 W |

Product description

- Intuitive control knob
- Variable heat retention function
- childproofing feature
- Cooking zone timers
- Timer
- Pause function
- automatic heat up function
- Increased resistance against breakage
- Modular system
- Demo mode

Scope of delivery

- Induction wok cooktop PKIW3
- 2 x control knobs
- 2 x connection cables for the control knobs
- Connection cable to the extractor
- operating and installation instructions
- height adjustment plate set
- mounting straps

Accessories

- HIW1 induction wok, Controlinduc[®], stainless steel, Ø 360 mm

product- and planning instructions

- The installation height of 128 mm means that the device cannot be installed over the exhaust ducting
- Ensure sufficient ventilation of the area below the cooktop.
- Glass ceramic mould Diameter 310 mm
- Use a wok that loses its magnetic properties when the temperature rises (overheating protection). We recommend using the BORA induction wok.

PKCH3

BORA Pro Hyper cooktop 1-ring/2-ring

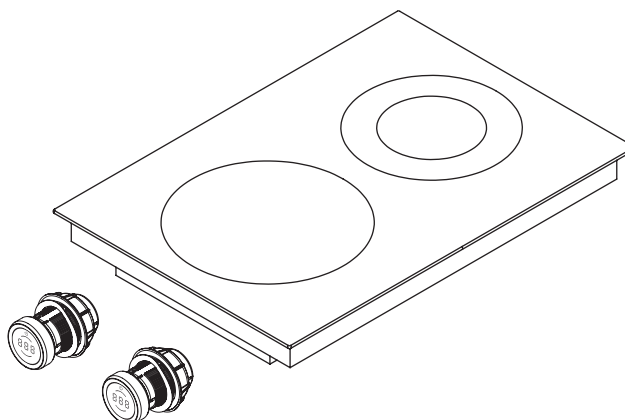
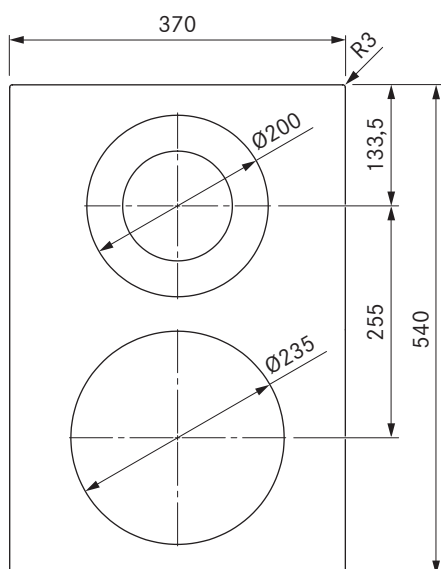
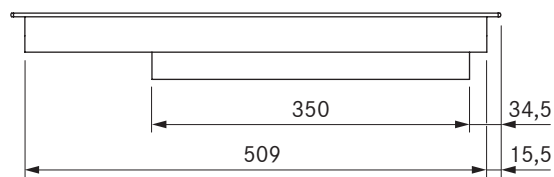
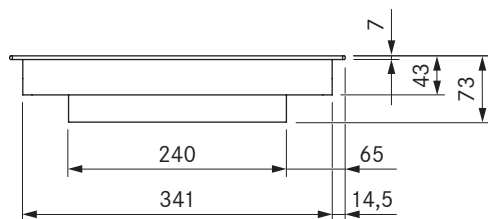

technical data

| | |
|---|-----------------------------------|
| Supply voltage | 380 - 415 V 2N |
| Frequency | 50/60 Hz |
| Maximum power consumption | 5.1 kW |
| Maximum power rating | 5.1 kW |
| Minimum fuse protection | 2 x 16 A |
| Power supply cable length | 1,5 m |
| Dimensions (width x depth x height) | 370 x 540 x 73 mm |
| Weight (incl. accessories/packaging) | 8.7 kg |
| Surface material | SCHOTT CERAN® |
| Cooktop power levels | 1 - 9 (switching of 2-ring/hyper) |
| Number of cooking zone circuits front | 1 |
| Number of cooking zone circuits rear | 2 |
| Size of front cooking zone | Ø 235 mm |
| Size of rear cooking zone | Ø 120 / 200 mm |
| Front cooking zone output | 2100 W |
| Rear cooking zone output | 800 / 1900 W |
| Front cooking zone power setting output | 3200 W |

Product description

- Intuitive control knob
- Variable heat retention function
- Super fast parboiling
- 2-ring switching
- childproofing feature
- Cooking zone timers
- Timer
- Pause function
- automatic heat up function
- Demo mode

Scope of delivery

- Hyper cooktop, 1-ring/2-ring PKCH3
- 2 x control knobs
- 2 x connection cables for the control knobs
- Connection cable to the extractor
- operating and installation instructions
- mounting straps
- height adjustment plate set

product- and planning instructions

- Rotation by 180° possible during installation
- Ensure sufficient ventilation of the area below the cooktop.

PKC3

BORA Pro HiLight cooktop 3-ring/2-ring

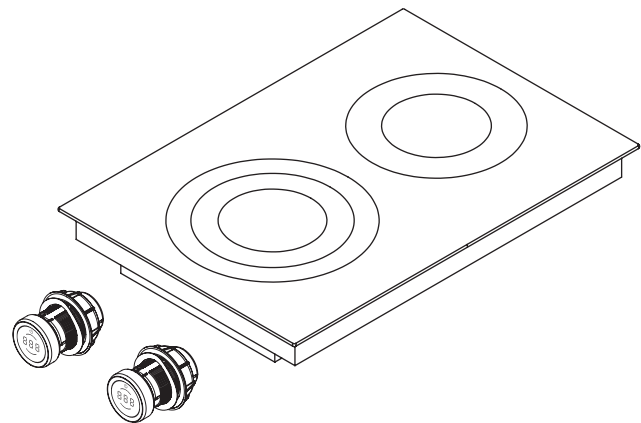
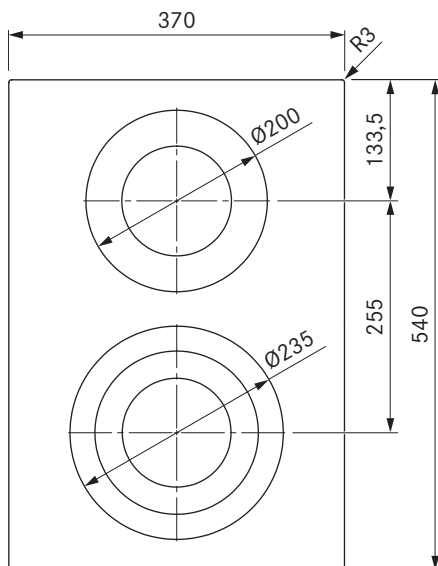
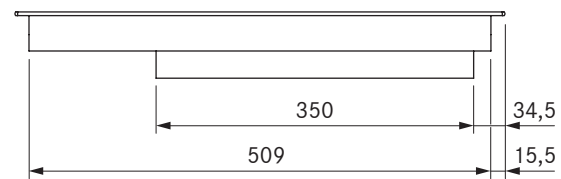
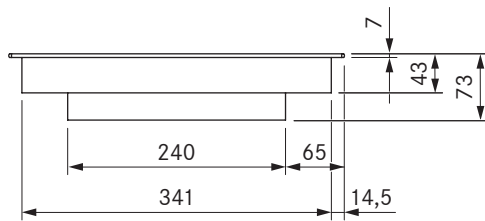

technical data

| | |
|---------------------------------------|--------------------------------|
| Supply voltage | 380 - 415 V 2N |
| Frequency | 50/60 Hz |
| Maximum power consumption | 4.4 kW |
| Maximum power rating | 4.4 kW |
| Minimum fuse protection | 2 x 16 A |
| Power supply cable length | 1,5 m |
| Dimensions (width x depth x height) | 370 x 540 x 73 mm |
| Weight (incl. accessories/packaging) | 8.7 kg |
| Surface material | SCHOTT CERAN® |
| Cooktop power levels | 1 - 9 (switching of 2/3 rings) |
| Number of cooking zone circuits front | 3 |
| Number of cooking zone circuits rear | 2 |
| Size of front cooking zone | Ø 120 / 180 / 235 mm |
| Size of rear cooking zone | Ø 120 / 200 mm |
| Front cooking zone output | 800 / 1600 / 2500 W |
| Rear cooking zone output | 800 / 1900 W |

Product description

- Intuitive control knob
- Variable heat retention function
- 2-ring switching
- 3-ring switching
- childproofing feature
- Cooking zone timers
- Timer
- Pause function
- automatic heat up function
- Demo mode

Scope of delivery

- HiLight cooktop, 3-ring/2-ring PKC3
- 2 x control knobs
- 2 x connection cables for the control knobs
- Connection cable to the extractor
- operating and installation instructions
- mounting straps
- height adjustment plate set

product- and planning instructions

- Rotation by 180° possible during installation
- Ensure sufficient ventilation of the area below the cooktop.

PKCB3

BORA Pro HiLight cooktop 3 ring/roaster

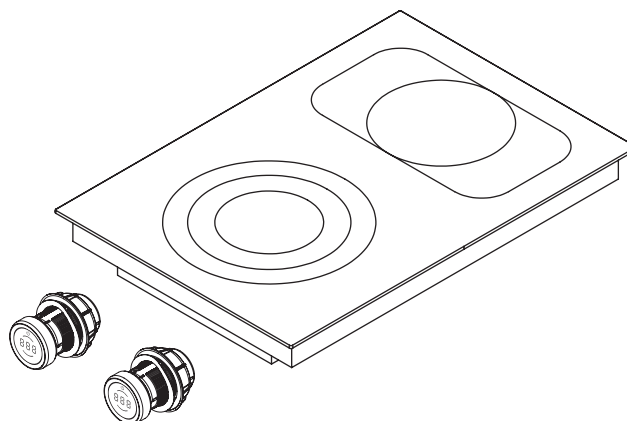
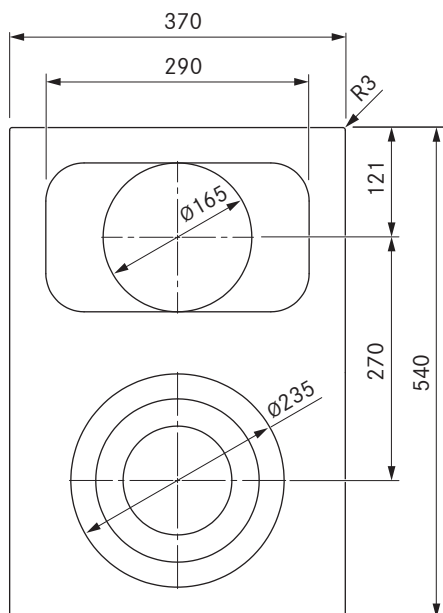
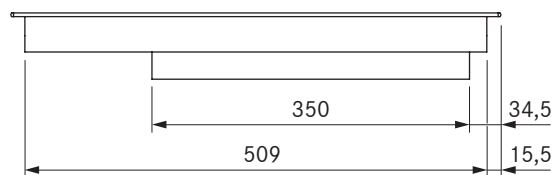
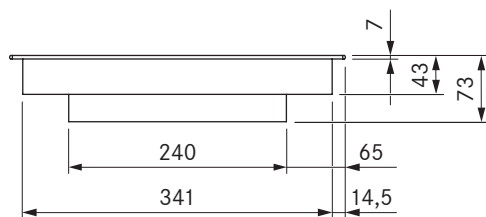

technical data

| | |
|---------------------------------------|--|
| Supply voltage | 380 – 415 V 2N |
| Frequency | 50/60 Hz |
| Maximum power consumption | 5.1 kW |
| Maximum power rating | 5.1 kW |
| Minimum fuse protection | 2 x 16 A |
| Power supply cable length | 1,5 m |
| Dimensions (width x depth x height) | 370 x 540 x 73 mm |
| Weight (incl. accessories/packaging) | 8.9 kg |
| Surface material | SCHOTT CERAN® |
| Cooktop power levels | 1 – 9 (switching of 2/3 rings/roaster) |
| Number of cooking zone circuits front | 3 |
| Number of cooking zone circuits rear | 2 |
| Size of front cooking zone | Ø 120 / 180 / 235 mm |
| Size of rear cooking zone | Ø 165 mm / 290 x 165 mm |
| Front cooking zone output | 800 / 1600 / 2500 W |
| Rear cooking zone output | 1500 W / 2600 W |

Product description

- Intuitive control knob
- Variable heat retention function
- Roaster switching
- 3-ring switching
- childproofing feature
- Cooking zone timers
- Timer
- Pause function
- automatic heat up function
- Demo mode

Scope of delivery

- HiLight cooktop, 3-ring/roaster PKCB3
- 2 x control knobs
- 2 x connection cables for the control knobs
- Connection cable to the extractor
- operating and installation instructions
- mounting straps
- height adjustment plate set

product- and planning instructions

- Rotation by 180° possible during installation
- Ensure sufficient ventilation of the area below the cooktop.

PKG3

BORA Pro gas cooktop

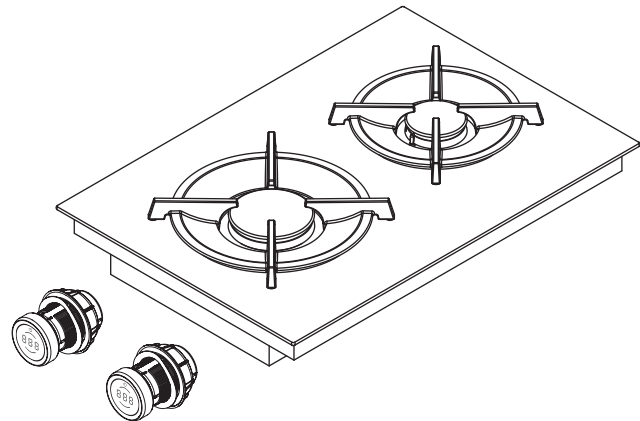
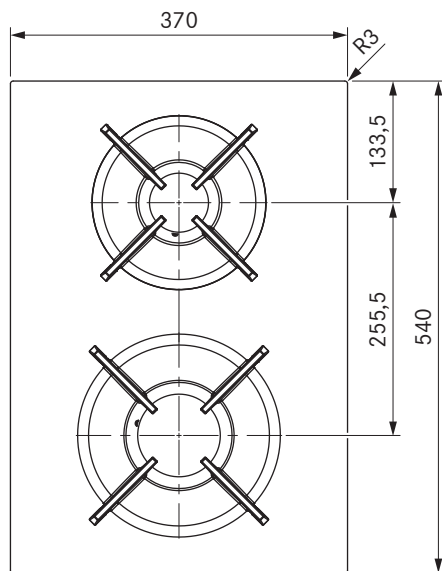
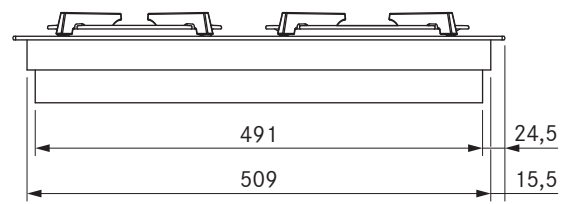
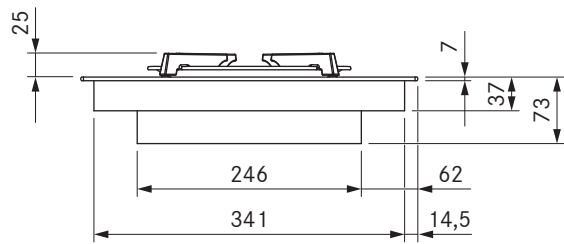

technical data

| | |
|--|----------------------|
| Supply voltage | 220 – 240 V |
| Frequency | 50/60 Hz |
| Maximum power consumption | 5.0 kW |
| Maximum power rating | 20 W |
| Minimum fuse protection | 1 x 0.5 A |
| Power supply cable length | 1,5 m |
| Dimensions (width x depth x height) | 370 x 540 x 73 mm |
| Weight (incl. accessories/packaging) | 11.5 kg |
| Surface material | SCHOTT CERAN® |
| Cooktop power levels | 1 – 9, P |
| Size of front cooking zone | Ø 240 mm |
| Size of rear cooking zone | Ø 200 mm |
| Front cooking zone output (power burner) | 800–3000 W |
| Rear cooking zone output (normal burner) | 550–2000 W |
| Size of front pan support | 270 x 270 x 25/50 mm |
| Size of rear pan support | 235 x 235 x 25/50 mm |

Product description

- Intuitive control knob
- Variable heat retention function
- Sunken gas burners
- Automatic reignition
- Dishwasher-safe pan supports
- childproofing feature
- automatic heat up function
- precise electronic control
- residual heat display
- Demo mode

Scope of delivery

- Gas cooktop PKG3
- 2 x control knobs
- 2 x connection cables for the control knobs
- 2 x cast iron pan supports
- Gas nozzle set G20/20 mbar natural gas
- Flexible gas connection tube, length 500 mm, 1/2" external thread
- Connection cable to the extractor

- operating and installation instructions
- height adjustment plate set
- mounting straps
- Adapter cylindrical-conical
- Seal

Accessories

- BORA gas nozzle set natural gas G20/10 mbar PKGDS2010
- BORA gas nozzle set natural gas G20/13 mbar PKGDS2013
- BORA gas nozzle set natural gas G20/20 mbar PKGDS2020
- BORA gas nozzle set natural gas G25/20 mbar PKGDS2520
- BORA gas nozzle set natural gas G20/25 mbar PKGDS2025
- BORA gas nozzle set natural gas G25/25 mbar PKGDS2525
- BORA gas nozzle set liquid gas G30/G31 28-30/37 mbar PKGDS3028
- BORA gas nozzle set liquid gas G30/G31 50 mbar PKGDS3050
- BORA Pro gas nozzle set liquid gas G31/G30 mbar PKGDS3130
- BORA Pro gas nozzle set liquid gas G31/50 mbar PKGDS3150
- BORA burner set PKGBS
- BORA pan support small PKGTK
- BORA pan support large PKGTG

product- and planning instructions

- Ensure sufficient air supply below the gas cooktop. Either over the front of the body (opening cross-section > 50 cm²) or over the plinth area (opening cross-section > 150 cm²)
- Provide a return flow aperture (opening cross-section > 1000 cm² per air cleaning unit) for recirculation in the plinth area
- Please note the local regulations and connection requirements applicable to gas cooktops
- Please note the special installation and workmanship guidelines for the gas cooktop (see the operating and installation instructions)
- When operating a gas cooktop with a cooktop extractor, the gas flame can be affected (depending on the height of the power level on the cooktop extractor)
- The performance characteristics of the gas cooktop (e.g. heating times, efficiency, etc.) are affected by the cooktop extractor. The cooktop extractor also affects the heat input and distribution
- If the gas cooktop is used in a model with two cooktop extractors, it is to be installed at the side
- Rotation by 180° possible during installation

PKT3

BORA Pro Tepan stainless steel grill

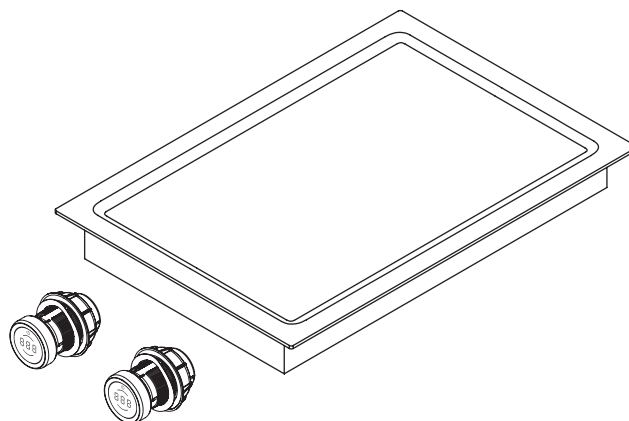
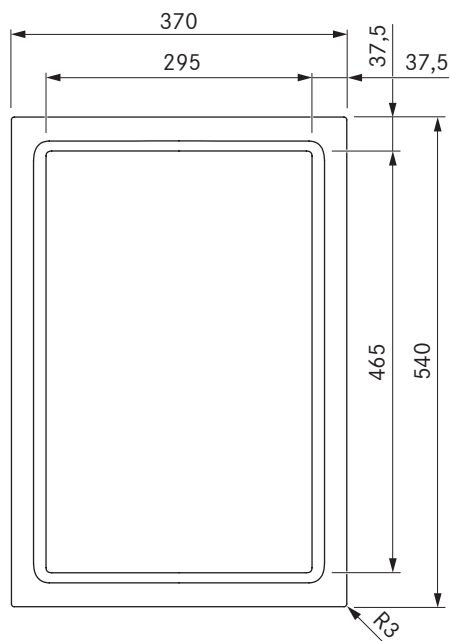
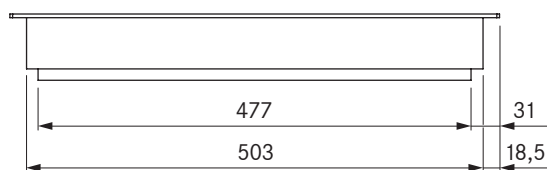
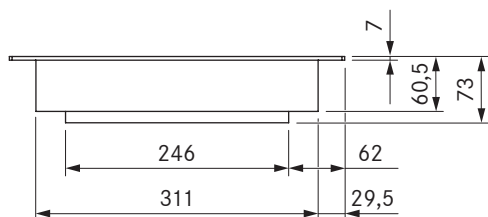

technical data

| | |
|--------------------------------------|--------------------------|
| Supply voltage | 380 – 415 V 2N |
| Frequency | 50/60 Hz |
| Maximum power consumption | 4.8 kW |
| Maximum power rating | 4.8 kW |
| Minimum fuse protection | 2 x 16 A |
| Power supply cable length | 1,5 m |
| Dimensions (width x depth x height) | 370 x 540 x 73 mm |
| Weight (incl. accessories/packaging) | 15.8 kg |
| Surface material | Stainless steel, brushed |
| Temperature control range | 70 – 250°C |
| Size of front cooking zone | 295 x 230 mm |
| Size of rear cooking zone | 295 x 230 mm |
| Bridged cooking zone dimensions | 295 x 460 mm |
| Front cooking zone output | 2400 W |
| Rear cooking zone output | 2400 W |
| Bridged cooking zone power | 4800 W |

Product description

- Intuitive control knob
- Accurate temperature control
- Accurate temperature display
- Rapid heating
- Stainless steel grill area with two cooking zones
- Designed for optimum cleaning
- Cleaning function
- childproofing feature
- bridging function
- Demo mode

Scope of delivery

- Tepan stainless steel grill PKT3
- 2 x control knobs
- 2 x connection cables for the control knobs
- Connection cable to the extractor
- operating and installation instructions
- PTTS1 Tepan scraper
- height adjustment plate set
- mounting straps

product- and planning instructions

- Ensure sufficient ventilation of the area below the cooktop.

UESDRSL

BORA UNIVERSAL ARTICLE
ACCESSORIES

BORA universal Ecotube set with USDR50 and ULS

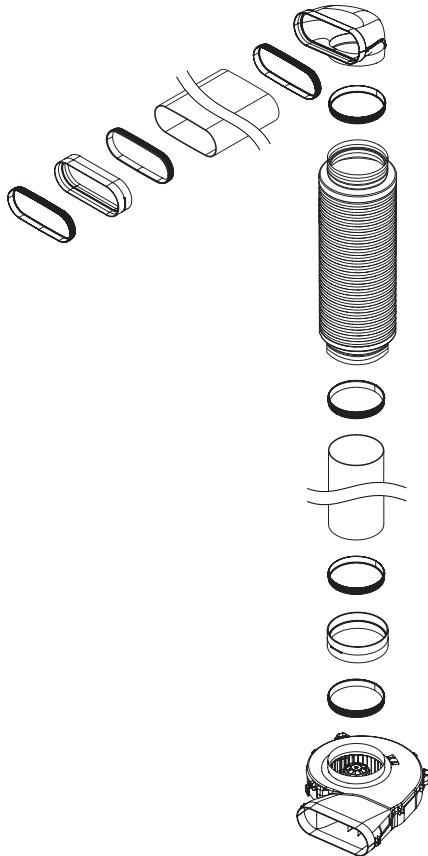

Product description

- Complete BORA system
- Integrated silencer and plinth fan
- Simple ordering
- 100% tight without additional taping
- Including required Ecotube seals

Scope of delivery

- 1 x shallow duct connector EFV/1
- 1 x shallow duct 750mm EF750/1
- 1 x 90° transition shallow round EFR90/1
- 1 x round silencer 500mm USDR50
- 1 x round duct 750mm ER750/1
- 1 x round duct connection ERV/1
- 1 x Plinth fan ULS
- 3 x flat seal EFD/1
- 4 x round seal ERD/1

UESDFSL

BORA UNIVERSAL ARTICLE
ACCESSORIES

BORA universal Ecotube set with USDF and ULS

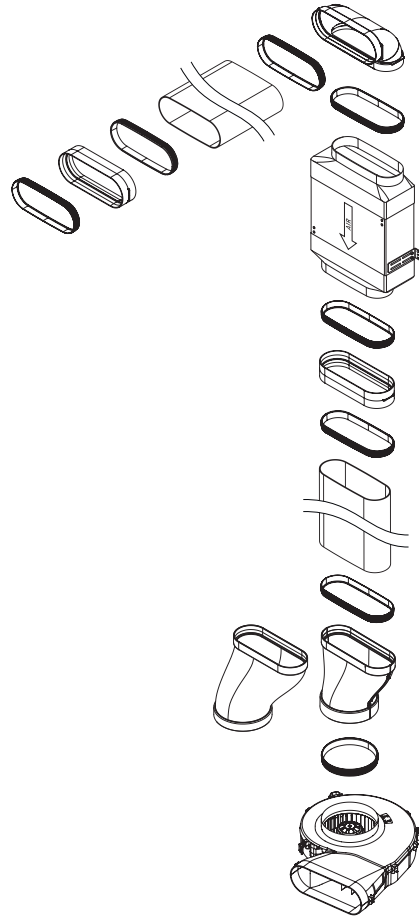

Product description

- Complete BORA system
- Integrated silencer and plinth fan
- Simple ordering
- 100% tight without additional taping
- Including required Ecotube seals

Scope of delivery

- 2 x shallow duct connector EFV/1
- 1 x shallow duct 750mm EF750/1
- 1 x 90° bend shallow vertical EFBV90/1
- 1 x shallow silencer USDF
- 1 x transition flat round straight EFRG/1
- 1 x transition shallow round offset 110mm EFRV110/1
- 1 x Plinth fan ULS
- 7 x flat seal EFD/1
- 1 x round seal ERD/1

Control knob

BORA Pro control knob

Appliance and installation dimensions

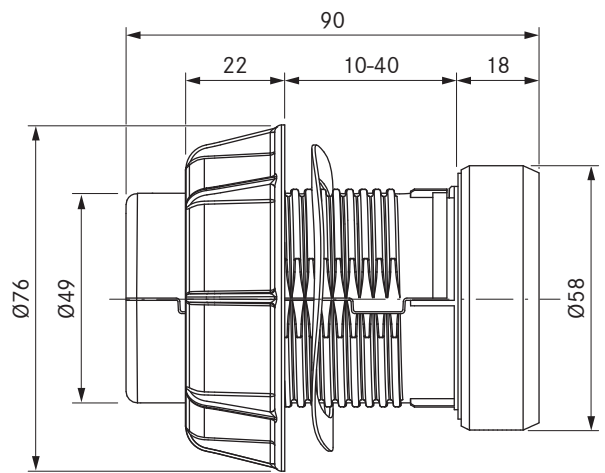
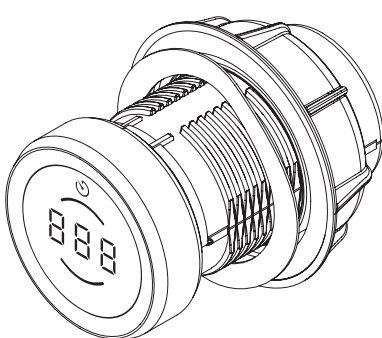

Bore holes

Bore hole for the control knob on the Professional cooktop extractor:

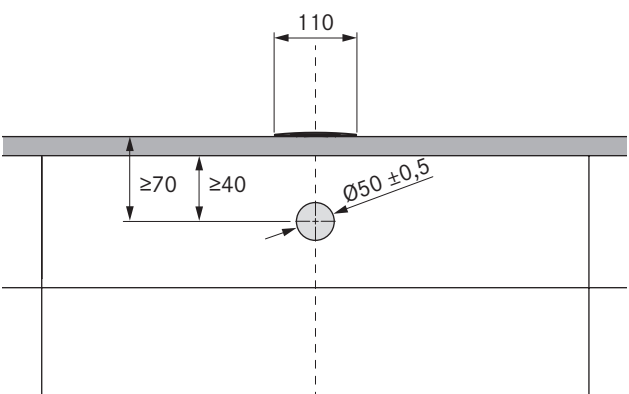

Bore holes for the control knobs on the Professional cooktops:

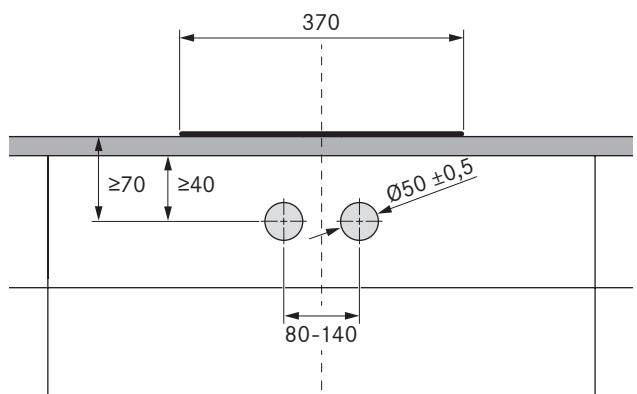

Bore hole examples

Bore holes for installing 2 cooktops, 1 cooktop extractor and 2 sockets

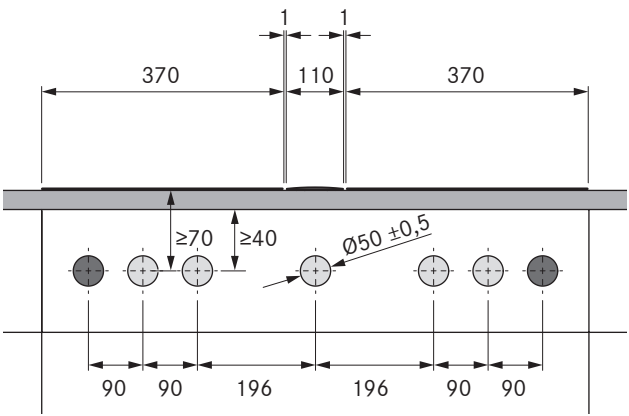

Bore holes for installing 3 cooktops, 2 cooktop extractors and 2 sockets

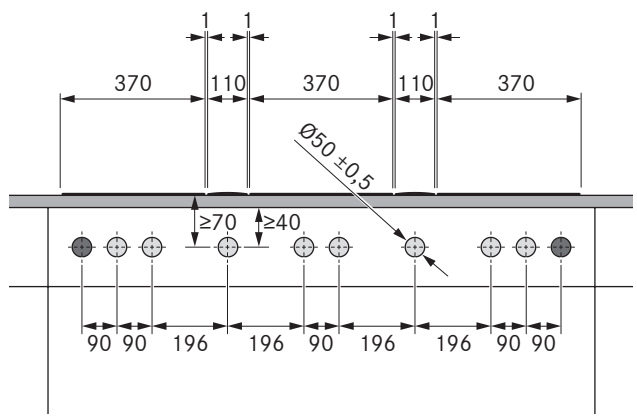

⊕ = Control knob bore holes ⊙ = Socket bore holes

Cut-out dimensions



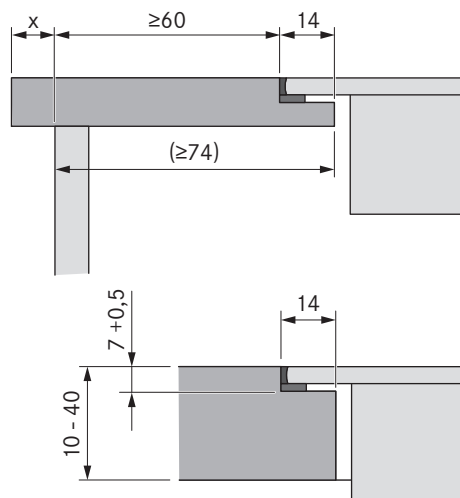

BORA Professional 3.0



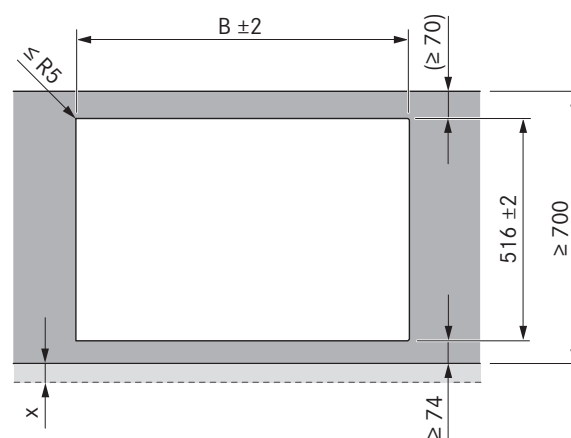
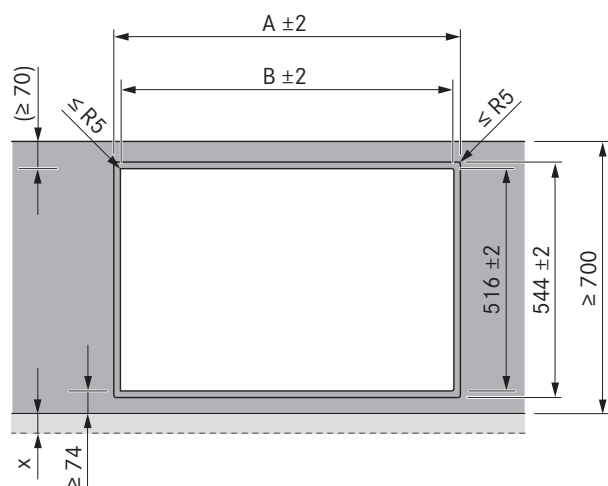
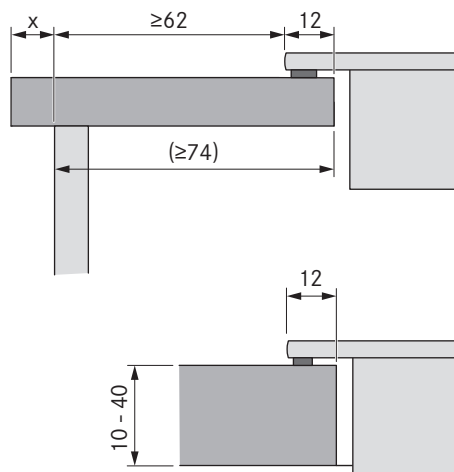

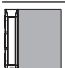
Flush installation



Surface mounting

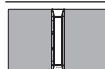

| Cooktops/cooktop extractor | A in mm | B in mm |
|---|---------|---------|
|  | 1/0 | 374 |
|  | 1/1 | 485 |
|  | 2/1 | 856 |
|  | 3/2 | 1338 |
|  | 4/2 | 1709 |

| Cooktops/cooktop extractor | B in mm |
|--|---------|
|  | 1/0 |
|  | 1/1 |
|  | 2/1 |
|  | 3/2 |
|  | 4/2 |

Important planning instructions:

- All dimensions from the front edge of the front cover.
- Cut-out dimensions tolerance ± 2 mm.
- Clearance of 1 mm should be planned between the built-in appliances.
- Clearance of 2 mm should be planned around the built-in appliances.
- Please note the worktop manufacturer's instructions with regard to the suitability of the worktop. Worktop cut-outs must be moisture-sealed using suitable means or, where necessary, fitted with a thermal insulator (e.g. in the case of Corian or HiMacs worktops).

Installation cut-outs

BORA Professional 3.0

Installation cut-out PKA3 with shallow silencer USDF, shallow duct connector EFV and straight transition piece EFRG (kitchen island):

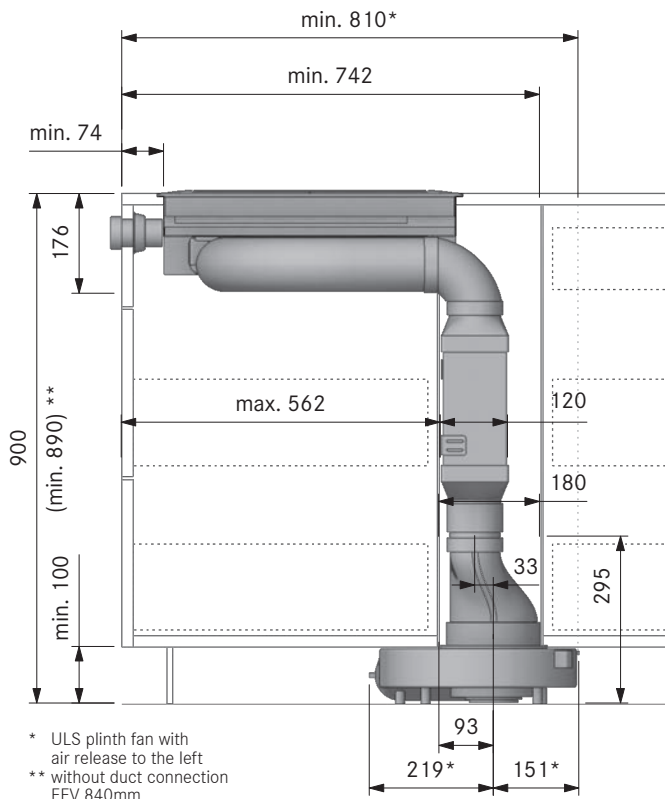

Installation cut-out PKA3 with shallow silencer USDF, shallow duct connector EFV and flat round offset EFRV110 (kitchen counter 700):

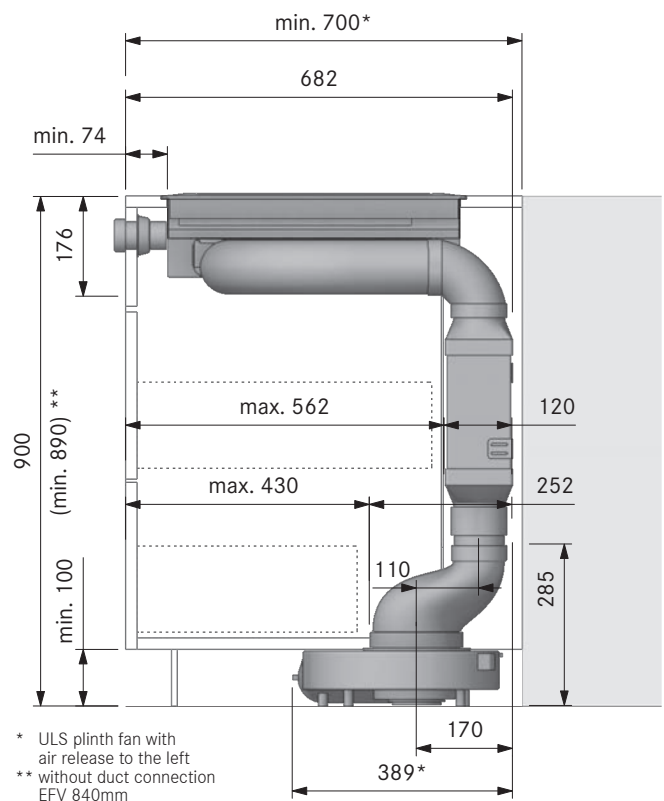

Installation cut-out PKA3 with round silencer USDR50 and round duct connection ERV (kitchen island):

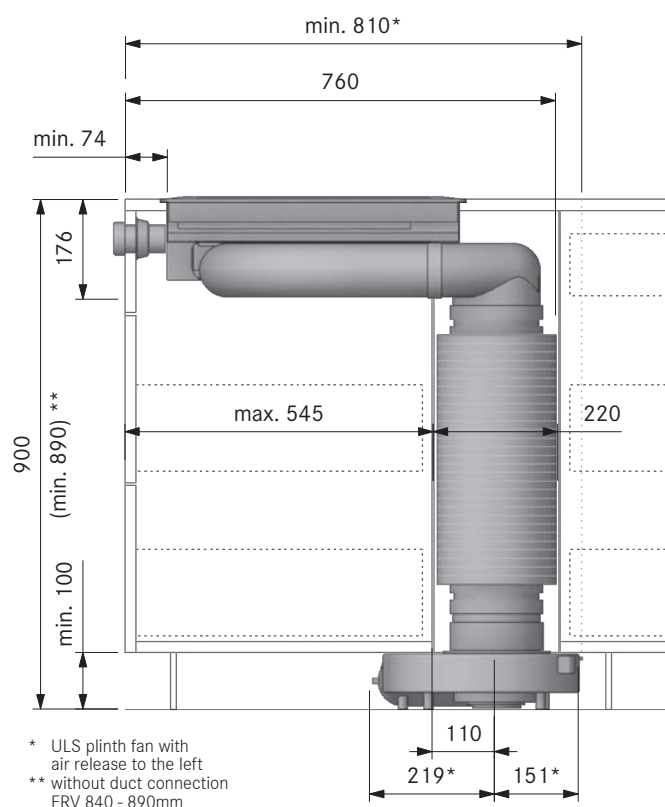

Installation cut-out PKA3 with Ecotube shallow duct:

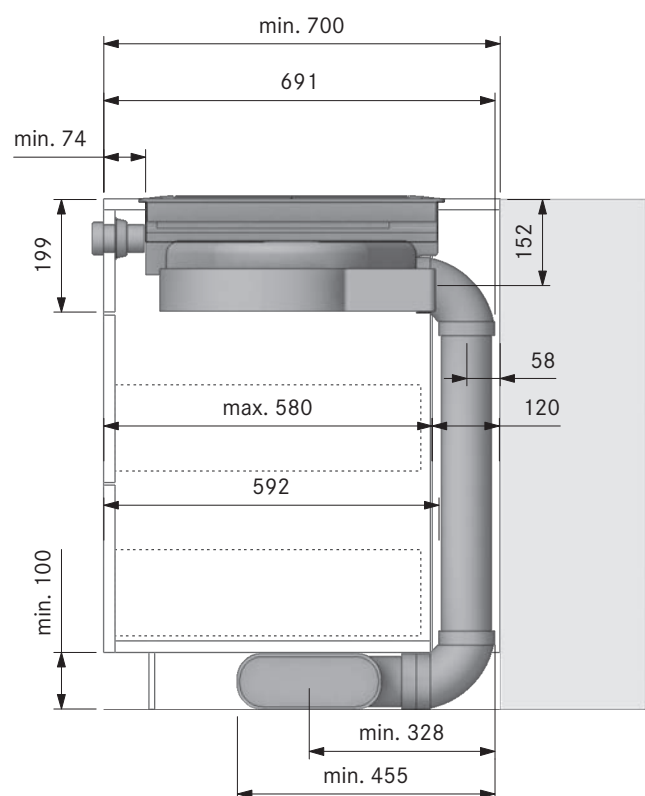

Minimum dimensions for installation

BORA Professional 3.0

Minimum dimensions for installation PKA3 + UESDFSL:

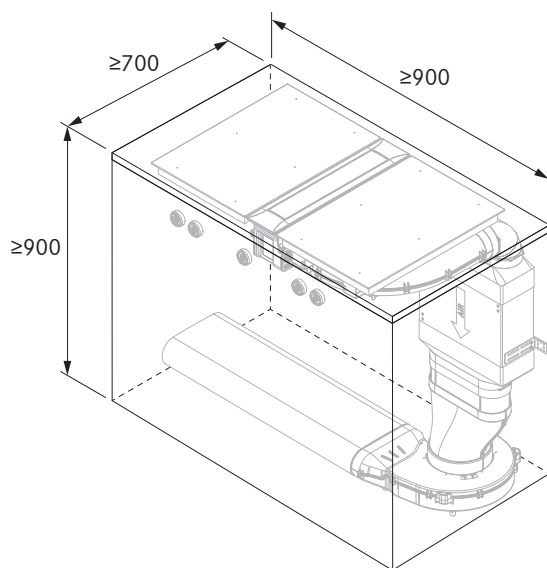

(The bottom drawer must be shortened,
ULS plinth fan with air release to the left)

Minimum dimensions for installation PKA3 + UESDRSL:

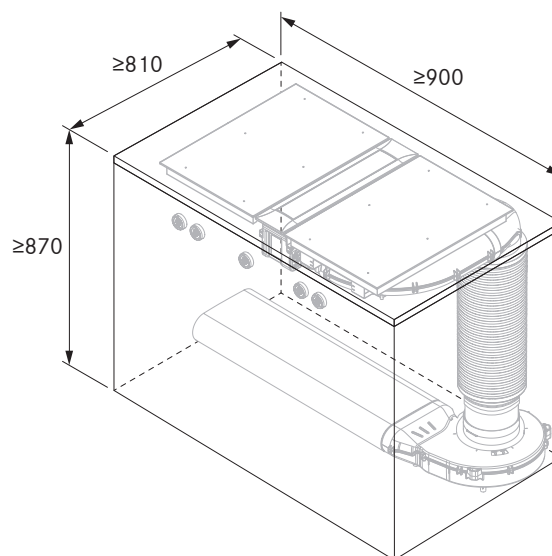

(ULS plinth fan with air release to the left)

Minimum dimensions for installation PKAS3 + EFBV90 + ULBF:

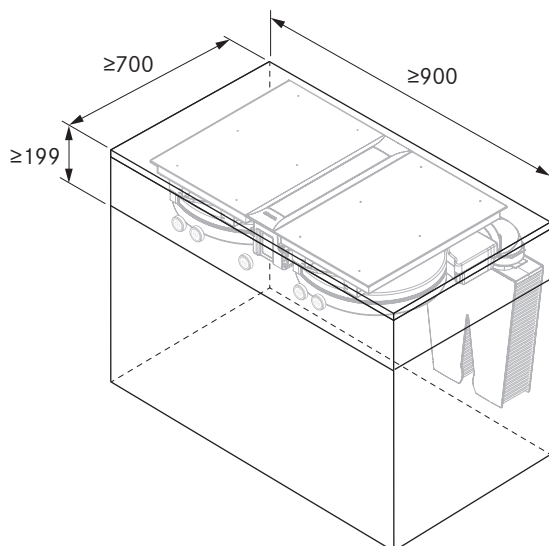

Minimum dimensions for installation 2 PKAS3 (exhaust system):

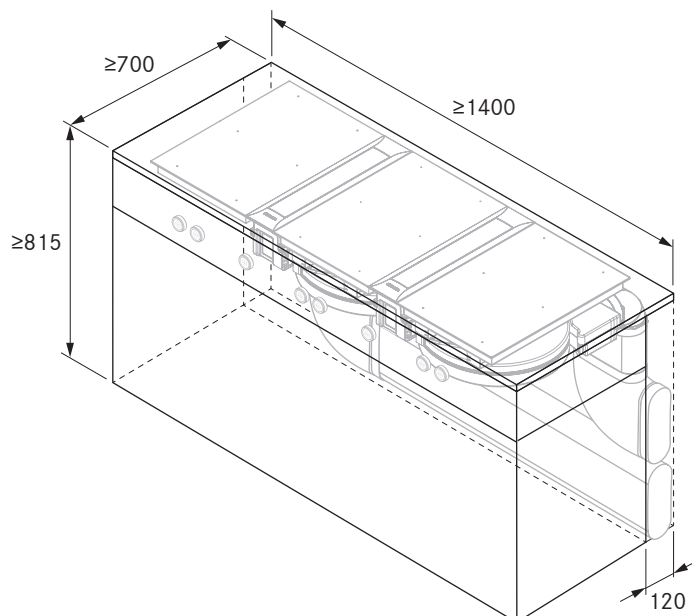

Duct connection dimensions

BORA Pro cooktop extractors

PKA3/PKA3AB cooktop extractor with curved duct element

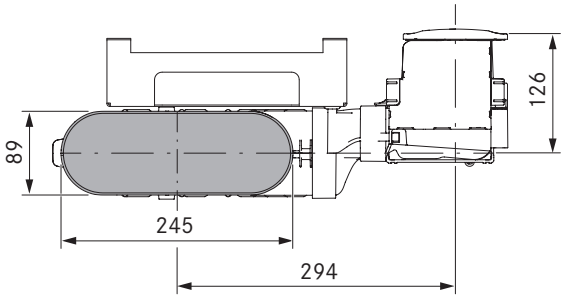
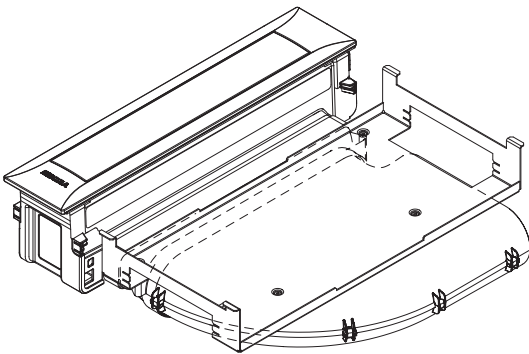

Installation option: PKA3/PKA3AB cooktop extractor with straight duct element

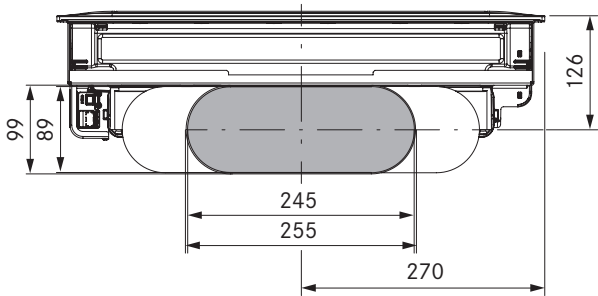
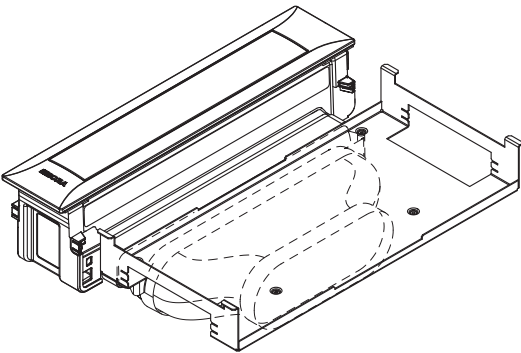

PKAS3/PKAS3AB cooktop extractor system

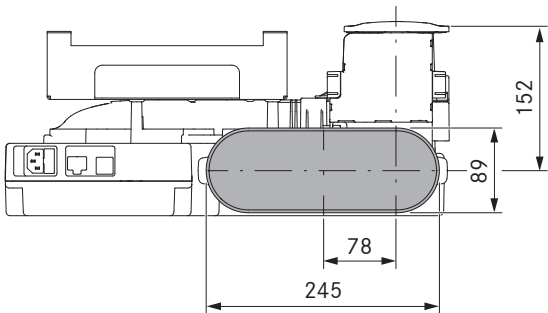
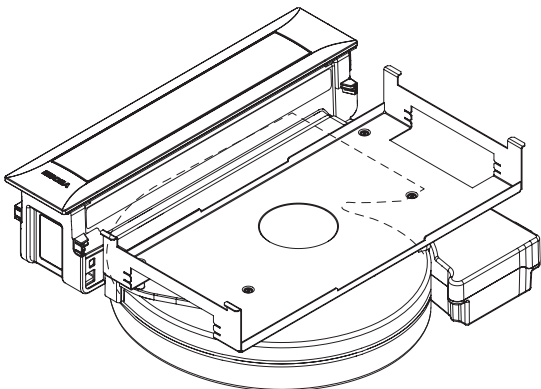

Core bore holes

BORA Professional 3.0

Minimum dimensions for core bore hole PKA3 with shallow silencer USDF and flat round straight transition EFRG (kitchen island):

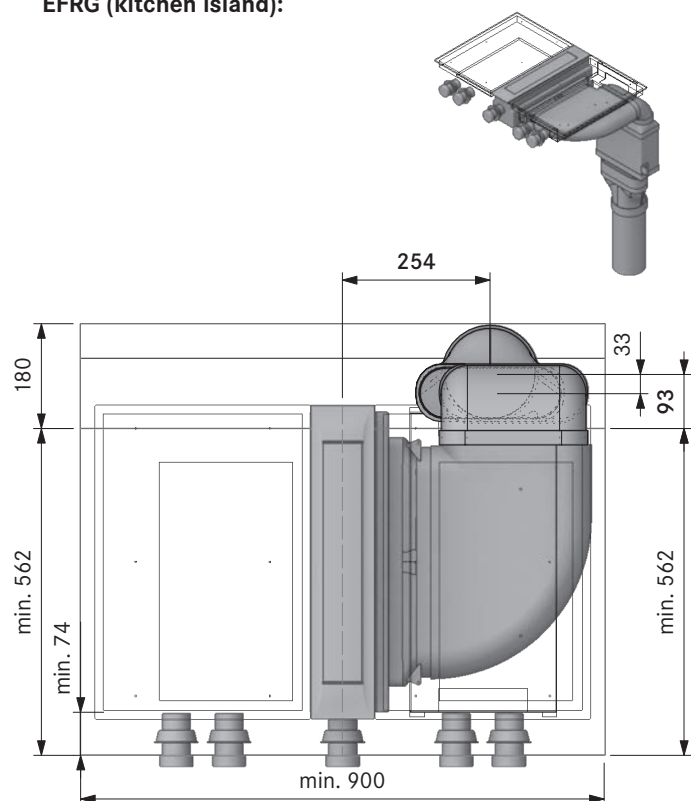

Mindestmaß Kernbohrung PKA3 with shallow silencer USDF flat round offset EFRV (kitchen counter):

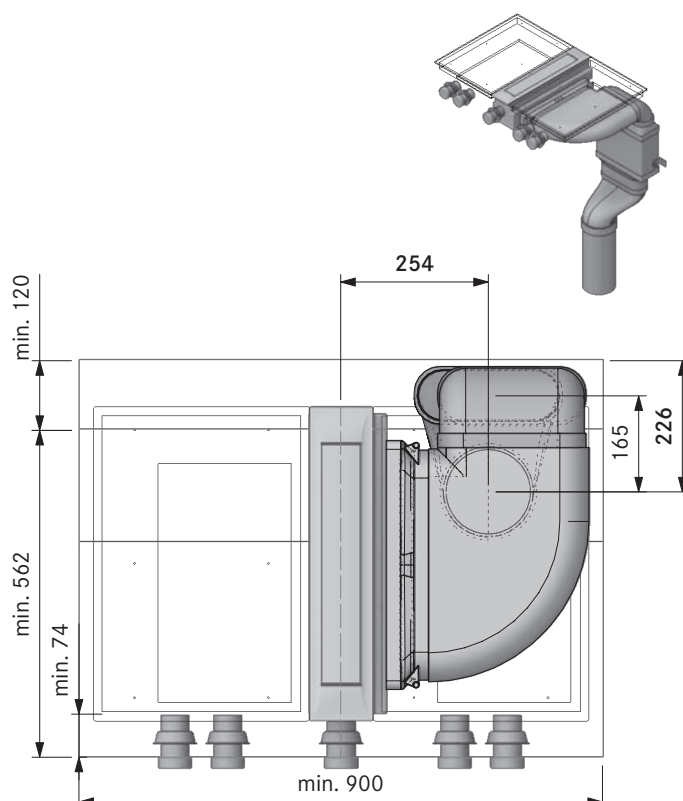

Minimum dimensions for core bore hole PKA3 with duct sound absorber USDR50 (kitchen island):

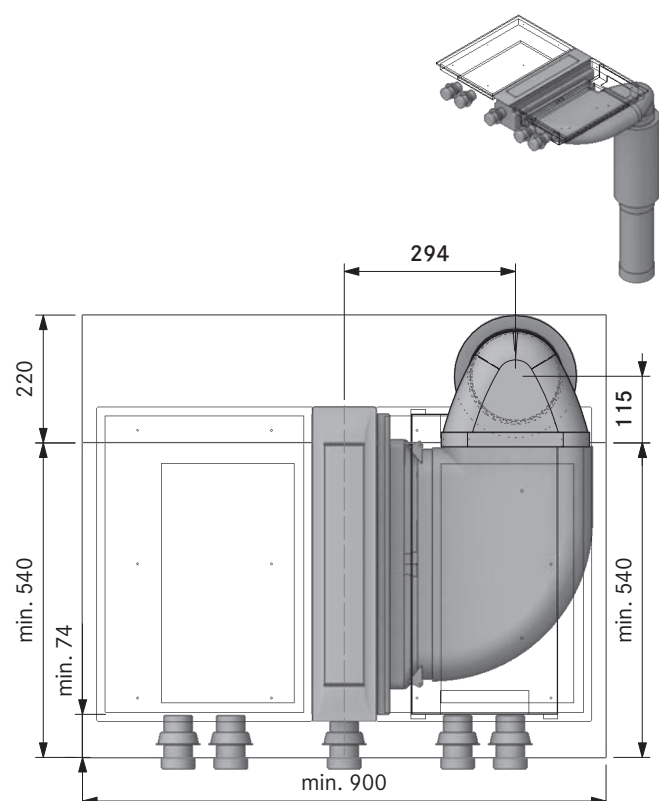

Minimum dimensions for core bore hole PKAS3 with shallow duct EF750 and bridge flat round straight EFRG (kitchen counter):

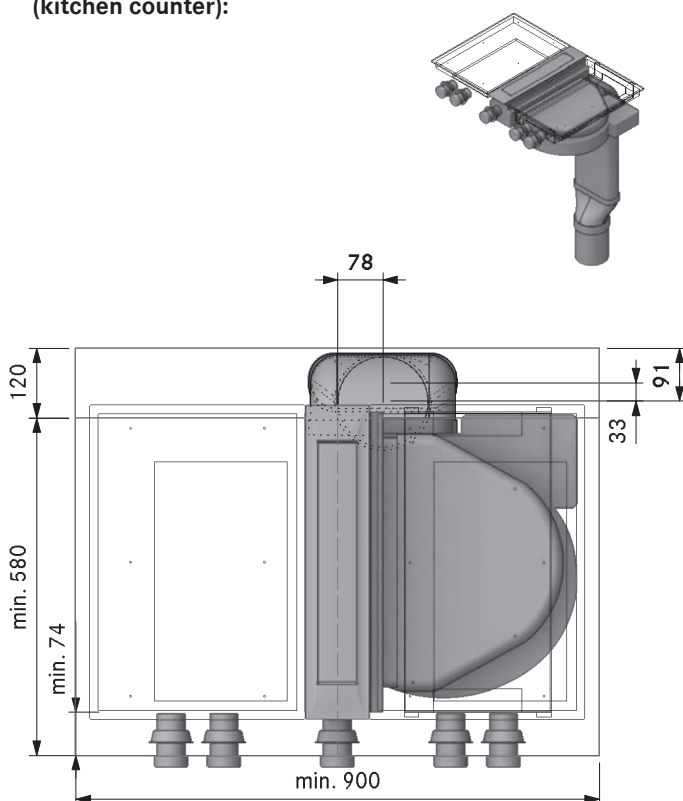

Connection diagram

BORA Professional 3.0

BORA Pro cooktop extractor PKA3/PKA3AB

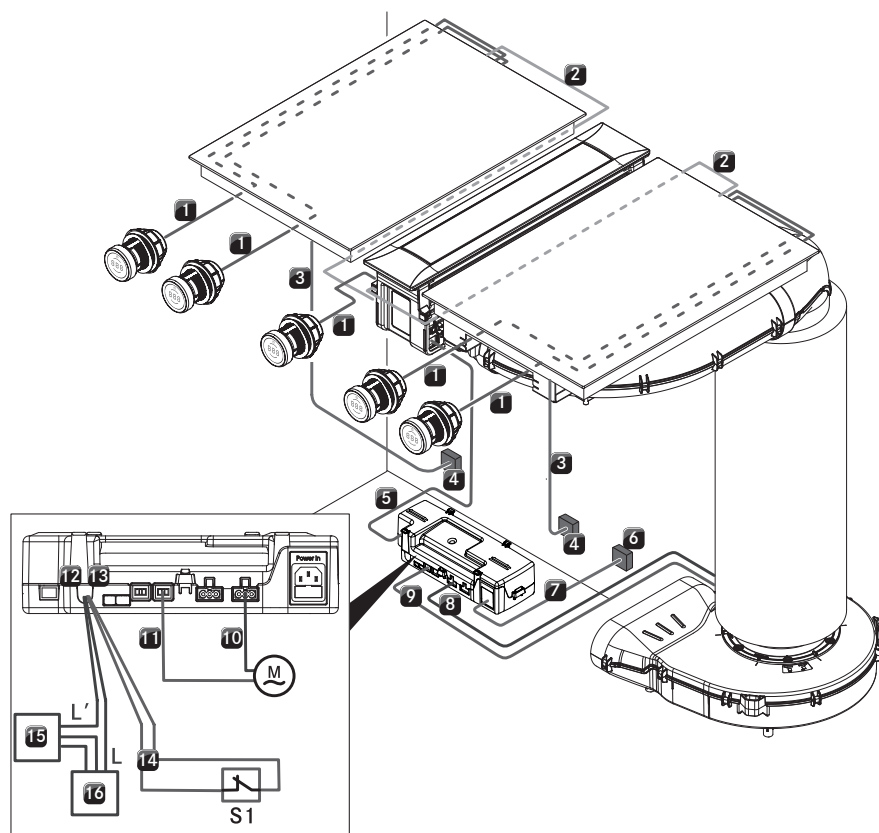

| Position | Description | Note |
|----------|---|--|
| 1 | Cable control knob – interface | Length 1 m |
| 2 | Automatic extraction system cable | Length 1 m |
| 3 | Cooktop power supply cable | Length 1.5 m |
| 4 | Power supply per cooktop: PKT3, PKC3, PKCB3, PKCH3 PKFI3, PKI3, PKIW3 PKG3 | L1/L2 /N/PE min. fuse protection 2 x 16 A L/N/PE min. fuse protection 1 x 16 A L/N/PE min. fuse protection 1 x 0.5 A |
| 5 | CAT 5 communication cable | Length 3 m |
| 6 | Control unit power supply | L/N/PE |
| 7 | Control unit power supply cable | Length 2 m (country-specific) |
| 8 | Fan 1 power supply cable | |
| 9 | Fan 1 control line | |
| 10 | Fan 2 power supply cable | |
| 11 | Fan 2 control line | |
| 12 | Home-Out connection | Maximum 250 VAC / 30 VDC, 2.5 A |
| 13 | Home-In connection | 24V DC / 100 mA |
| 14 | Connection cable Home-In | |
| 15 | External device | E.g. electrically operated wall sleeve |
| 16 | Power supply for external device | |
| M | Fan 2 | |
| S1 | External switch contact | e.g. window contact switch for operating in exhaust mode with flues/fireplaces |

The connection diagram shows the maximum connection options required and is for planning purposes only.

The connection itself must be carried out by a qualified specialist based on the operating instructions.

Connection diagram

BORA Professional 3.0

BORA Pro cooktop extractor system PKAS3/PKAS3AB

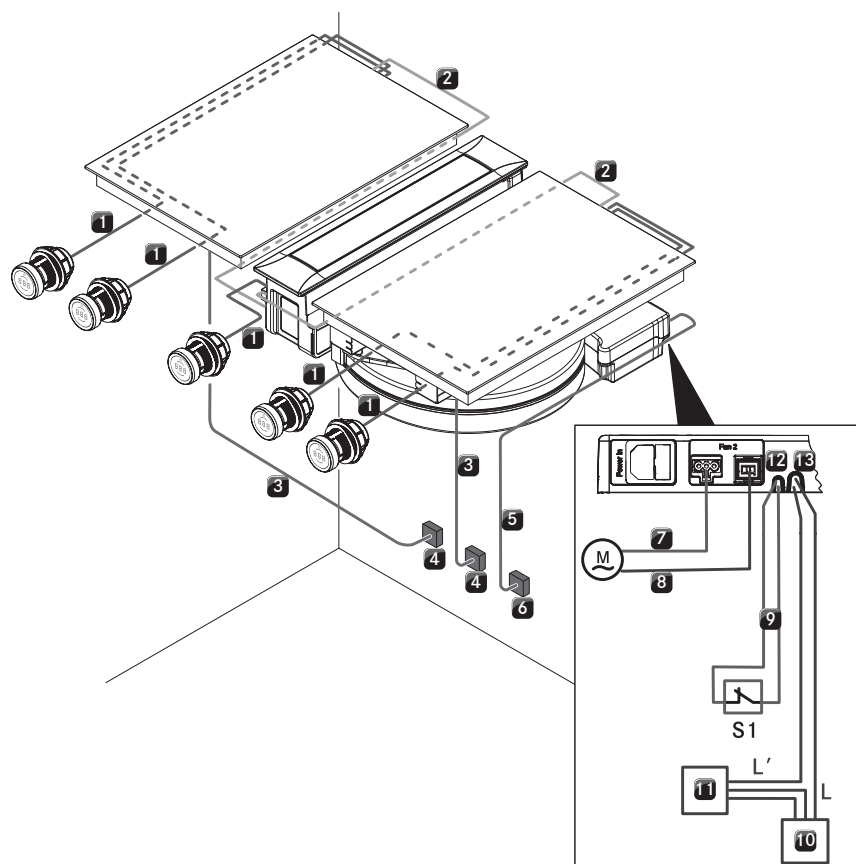

| Position | Description | Note |
|----------|---|--|
| 1 | Cable control knob – interface | Length 1 m |
| 2 | Automatic extraction system cable | Length 1 m |
| 3 | Cooktop power supply cable | Length 1.5 m |
| 4 | Power supply per cooktop: PKT3, PKC3, PKCB3, PKCH3 PKFI3, PKI3, PKIW3, PKG3 | L1/L2/N/PE min. fuse protection 2 x 16 A L/N/PE min. fuse protection 1 x 16 A |
| 5 | PKAS3/PKAS3AB power supply cable | Length 2 m (country-specific) |
| 6 | PKAS3/PKAS3AB power supply | |
| 7 | Fan 2 power supply cable | |
| 8 | Fan 2 control line | |
| 9 | Connection cable Home-In | |
| 10 | Power supply for external device | |
| 11 | External device | e.g. electrically operated wall sleeve |
| 12 | Home-In connection | 24V DC / 100 mA |
| 13 | Home-Out connection | Maximum 250 VAC/ 30 VDC, 2.5A |
| M | Fan 2 | |
| S1 | External switch contact | e.g. window contact switch for operating in exhaust mode with flues |

The connection diagram shows the maximum connection options required and is for planning purposes only.

The connection itself must be carried out by a qualified specialist based on the operating instructions.

Model plans

BORA Professional 3.0

see more model plans at <https://partner.bora.com>

PKA3 90° – Exhaust air model for kitchen units

MP_6125 with ULS plinth fan, USDF shallow silencer and airflow towards the left in the basement

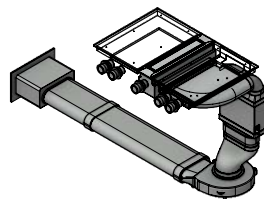
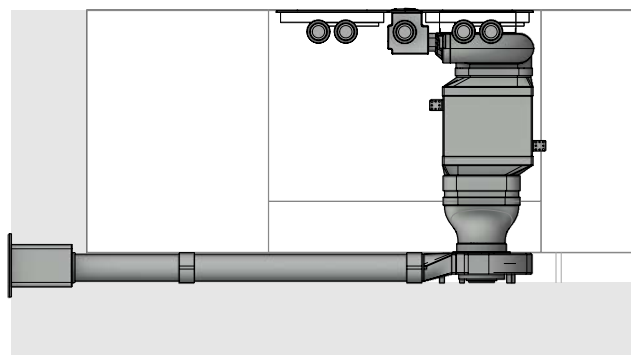
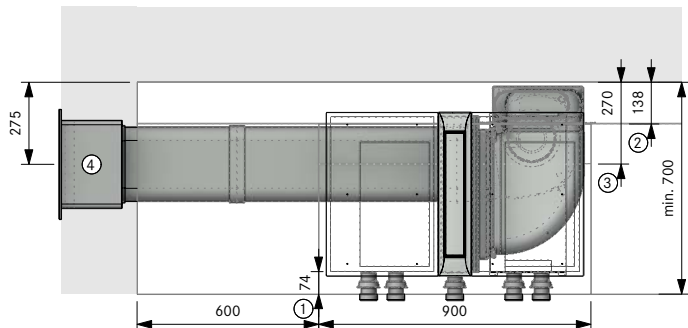

Planning instructions

- ① At least 74 mm from front edge to cut-out
- ② Space requirements for technology
- ③ The lowest outlet must be shortened
- ④ Wall opening 310 x 155 mm
71 mm from bottom edge of opening to centre of duct. Must expel air in a straight line regardless of the weather conditions

BORA product

- 1 PKA3 Pro Cooktop extractor
- 1 UESDFSL Universal Ecotube Set with USDF and ULS

BORA Ecotube product

- 2 EFV/1 duct connection, shallow
- 1 UEBF/1 3box wall sleeve
- 2 EF750/1 shallow duct 750 mm

Sealing material is included in the scope of delivery in the case of moulded parts with a socket design

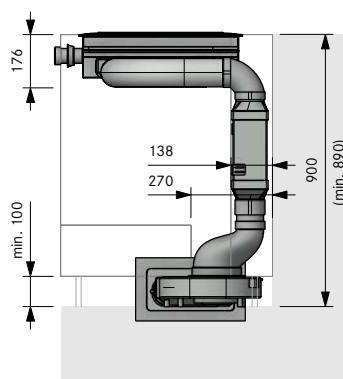

PKA3 straight – exhaust air model for kitchen units

MP_6408 with ULA external wall fan, USDF shallow silencer and air flow towards the right under the worktop

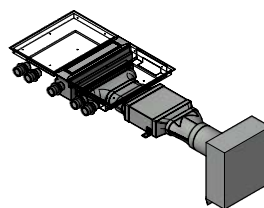
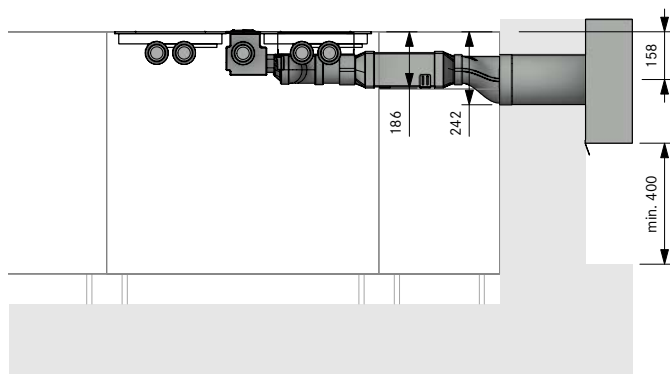
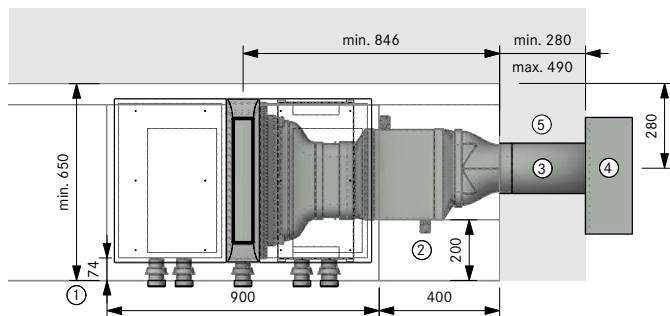

Planning instructions

- ① At least 74 mm from front edge to cut-out
- ② The highest outlet must be shortened
- ③ Core bore hole at least Ø 180 mm
- ④ Must be able to expel air downwards freely at least 400 mm
- ⑤ Empty Ø 40 mm pipe for control line and mains cable

BORA product

- 1 PKA3 Pro Cooktop extractor
- 1 ULA external wall fan EC
- 1 USDF shallow silencer

BORA Ecotube product

- 1 EFRG/1 transition, shallow round straight
- 1 EF750/1 shallow duct 750 mm

Sealing material is included in the scope of delivery in the case of moulded parts with a socket design

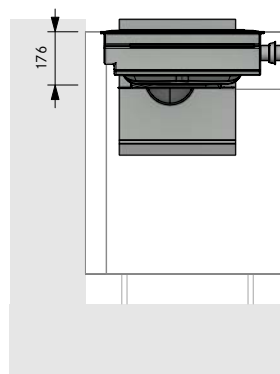

PKA3 90° – exhaust air model for kitchen units

MP_6210 with with ULS plinth fan, USDR50 round silencer and air flow to the right in the plinth

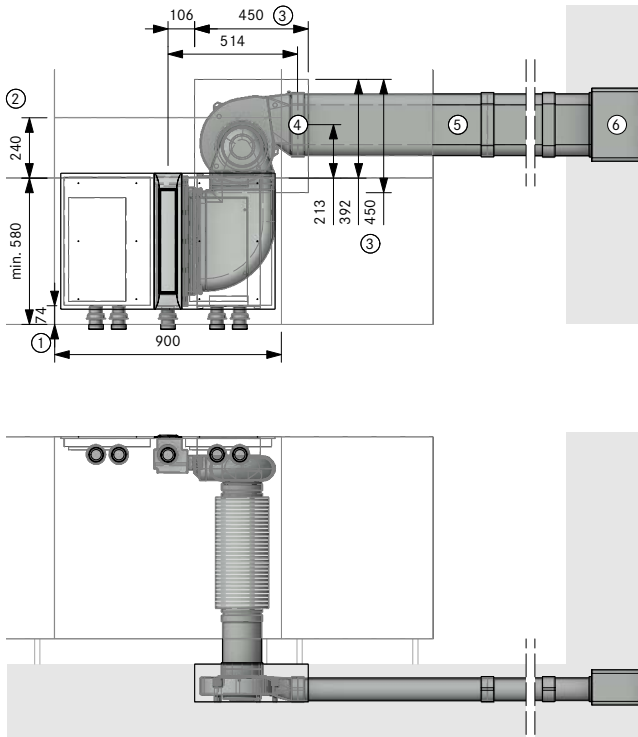

Planning instructions

- ① At least 74 mm from front edge to cut-out
- ② Space requirements for technology
- ③ Floor recess for ULS
- ④ Ecotube connection point
- ⑤ Fitted in floor installation according to DIN 18560-2 (fully integrated in the levelling layer). If the structure deviates from DIN 18560-2, reinforced screed must be provided for
- ⑥ Wall opening 310 x 155 mm
71 mm from bottom edge of opening to centre of duct. Must expel air in a straight line regardless of the weather conditions

BORA product

- 1 PKA3 Pro Cooktop extractor
- 1 UESDFSL Universal Ecotube Set with USDF and ULS

BORA Ecotube product

- 1 EFV/1 duct connection, shallow
- 1 UEBF/1 3box wall sleeve
- 1 EFS750/1 shallow duct with partition 750 mm

Sealing material is included in the scope of delivery in the case of moulded parts with a socket design

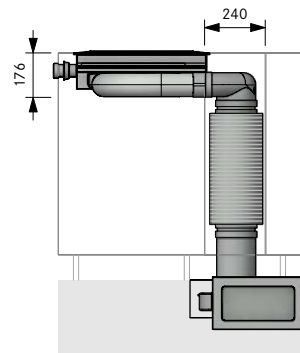

PKA3 90° - exhaust air model for kitchen islands

MP_6315 with ULI duct fan, USDR50 round silencer and air flow to the right in the basement

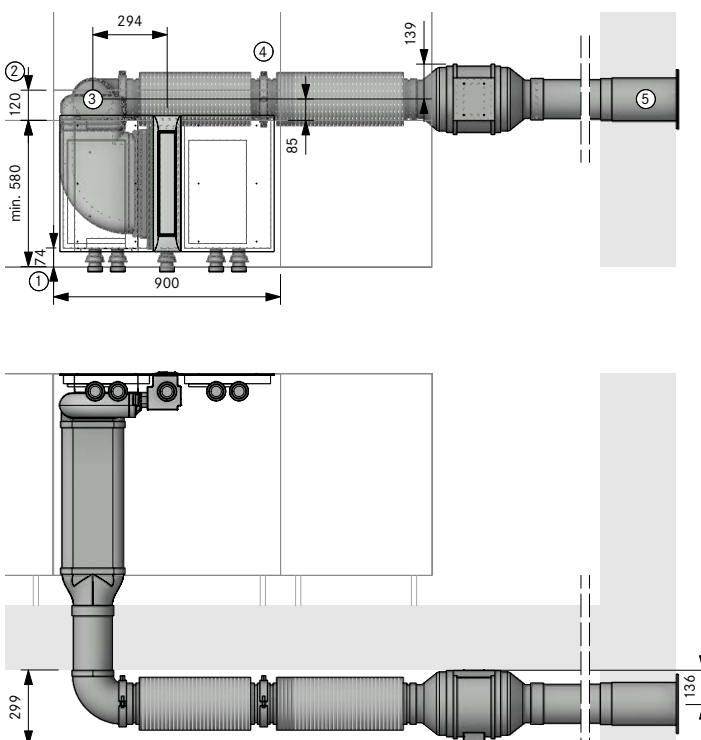

Planning instructions

- ① At least 74 mm from front edge to cut-out
- ② Space requirements for technology
- ③ Core bore hole at least Ø 180 mm
- ④ One mounting bracket set per Ecotube product with moulded coupling
- ⑤ Core bore hole at least Ø 180 mm
Must expel air in a straight line regardless of the weather conditions

BORA product

- 1 PKA3 Pro Cooktop extractor
- 1 ULI duct fan EC
- 2 USDR50 round silencer 500 mm

BORA Ecotube product

- 1 EFBV90/1 90° bend, shallow vertical
- 1 EFRG/1 transition, shallow round straight
- 1 ERB90/1 90° bend, round
- 1 UEBR/1 3box wall sleeve, round
- 1 EF750/1 shallow duct 750 mm
- 1 ER750/1 round duct 750 mm

BORA Ecotube product according to requirements

- ERV/1 duct connection, round
- ER750/1 round duct 750 mm
- ERMS/1 installation set, round

Sealing material is included in the scope of delivery in the case of moulded parts with a socket design

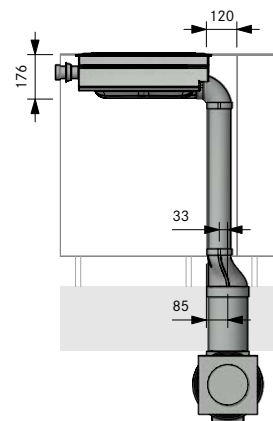

Model plans

BORA Professional 3.0

see more model plans at <https://partner.bora.com>

PKA3 straight – recirculation model for kitchen units

MP_6135 with ULS plinth fan, USDR50 round silencer and ULB3X air cleaning box

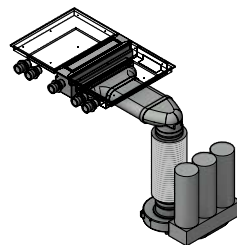
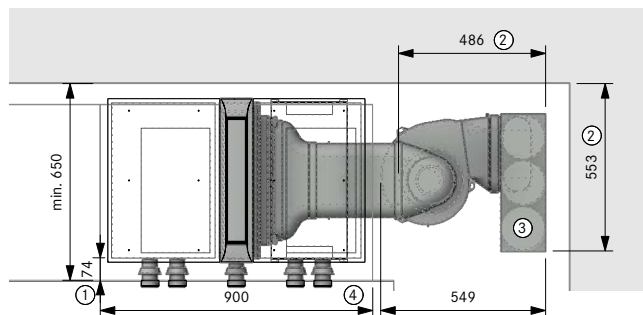

Planning instructions

- ① At least 74 mm from front edge to cut-out
- ② Space requirements for technology
- ③ The air cleaning box must be accessible to be able to replace filter cartridges and fine filters. Recommended space requirement (WxD) 800 x 180 mm or unobstructed 500 cm² free outflow area
- ④ Unobstructed return flow aperture at least 500 cm² per air cleaning box (at least 1000 cm² in the case of gas cooktops)

BORA product

- 1 PKA3 Pro Cooktop extractor
- 1 UESDRSL Universal Ecotube Set with USDR50 and ULS
- 1 ULB3X air cleaning box 3

BORA Ecotube product

- 1 EFBV90/1 90° bend, shallow vertical
- Sealing material is included in the scope of delivery in the case of moulded parts with a socket design**

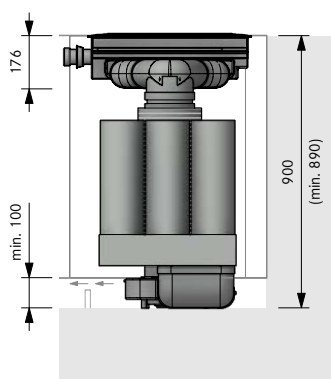
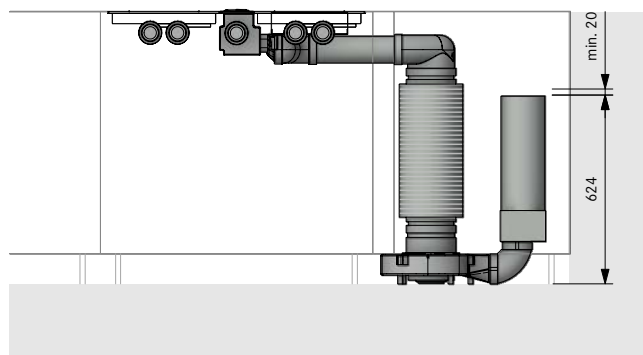

PKA3 90° – recirculation model for kitchen islands

MP_6127 with ULS plinth fan, USDF shallow silencer and standing ULB3X air cleaning box

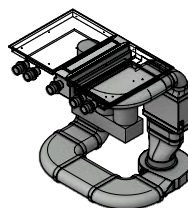
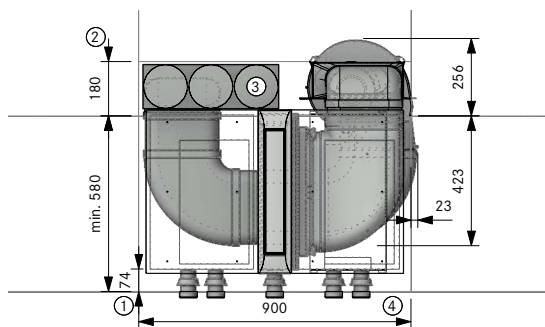

Planning instructions

- ① At least 74 mm from front edge to cut-out
- ② The highest outlet must be shortened
- ③ The air cleaning box must be accessible to be able to replace filter cartridges and fine filters. Recommended space requirement (WxD) 800 x 180 mm or unobstructed 500 cm² free outflow area
- ④ Unobstructed return flow aperture at least 500 cm² per air cleaning box (at least 1000 cm² in the case of gas cooktops)

BORA product

- 1 PKA3 Pro Cooktop extractor
- 1 UESDFSL Universal Ecotube Set with USDF and ULS
- 1 ULB3X air cleaning box 3

BORA Ecotube product

- 2 EFBH90/1 90° bend, shallow horizontal
- 1 EFBV90/1 90° bend, shallow vertical
- 1 EF750/1 shallow duct 750 mm

Sealing material is included in the scope of delivery in the case of moulded parts with a socket design

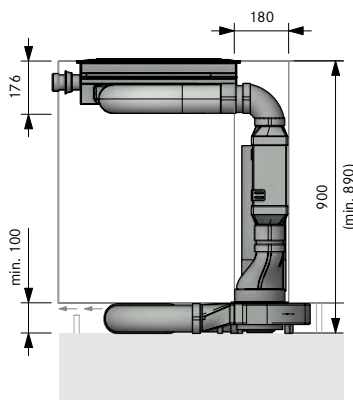
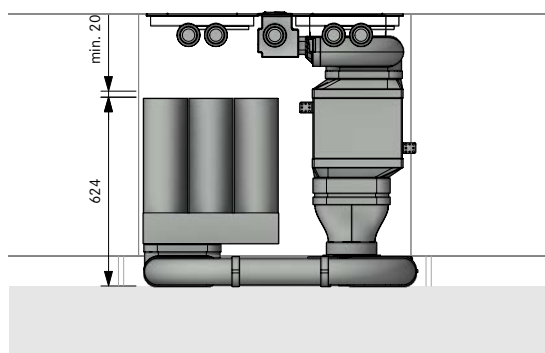

Model plans

BORA Professional 3.0

see more model plans at <https://partner.bora.com>

PKA3 90° – recirculation model for kitchen islands

MP_6161 with ULS plinth fan, USDR50 round silencer and standing ULB3X air cleaning box

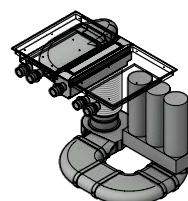
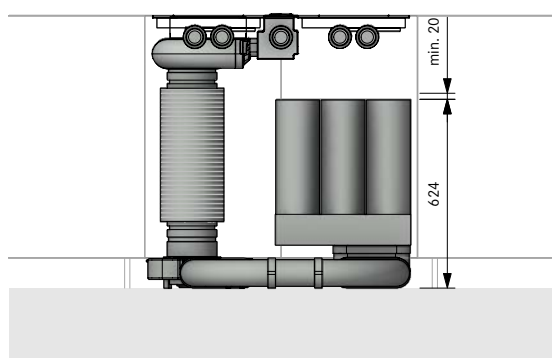
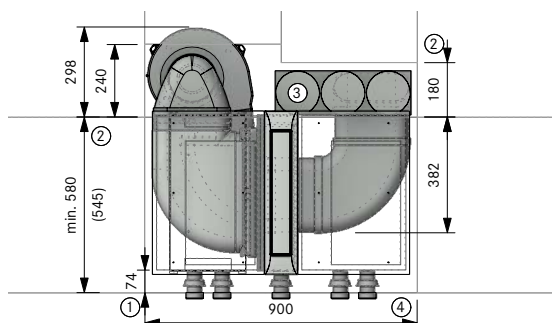

Planning instructions

- ① At least 74 mm from front edge to cut-out
- ② Space requirements for technology
- ③ The air cleaning box must be accessible to be able to replace filter cartridges and fine filters. Recommended space requirement (WxD) 800 x 180 mm or unobstructed 500 cm² free airflow area
- ④ Unobstructed return flow aperture at least 500 cm² per air cleaning box (at least 1000 cm² in the case of gas cooktops)

BORA product

- 1 PKA3 Pro Cooktop extractor
1 UESDRSL Universal Ecotube Set
with USDR50 and ULS
1 ULB3X air cleaning box 3

BORA Ecotube product

- 2 EFBH90/1 90° bend, shallow horizontal
1 EFBV90/1 90° bend, shallow vertical
1 FF750/1 shallow duct 750 mm

Sealing material is included in the scope of delivery in the case of moulded parts with a socket design

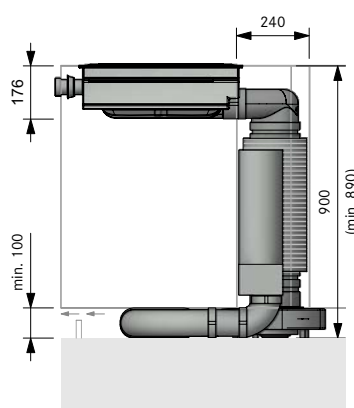

PKA3 90° - double recirculation model for kitchen islands

MP_6001 with ULS plinth fan, USDR50 round silencer and standing ULB3X air cleaning box

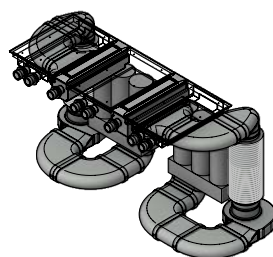
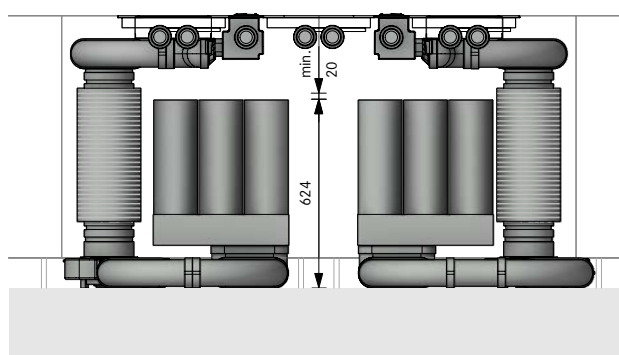
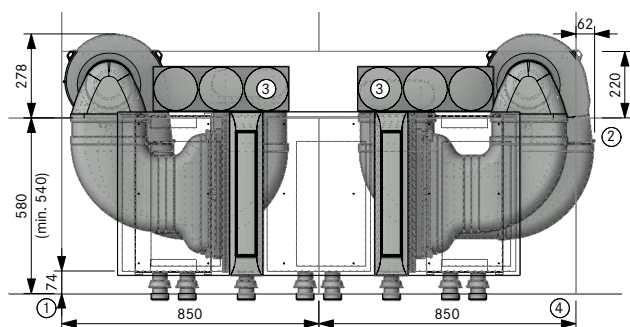

Planning instructions

- ① At least 74 mm from front edge to cut-out
- ② Space requirements for technology
- ③ The air cleaning box must be accessible to be able to replace filter cartridges and fine filters. Recommended space requirement (WxD) 800 x 180 mm or unobstructed 500 cm² free airflow area
- ④ Unobstructed return flow aperture at least 500 cm² per air cleaning box (at least 1000 cm² in the case of gas cooktops)

BORA product

- 2 PKA3 Pro Cooktop extractor
2 UESDRSL Universal Ecotube Set
with USDR50 and ULS
2 ULB3X air cleaning box 3

BORA Ecotube product

- 6 EFBH90/1 90° bend, shallow horizontal
2 EFBV90/1 90° bend, shallow vertical
1 EF750/1 shallow duct 750 mm

Sealing material is included in the scope of delivery in the case of moulded parts with a socket design

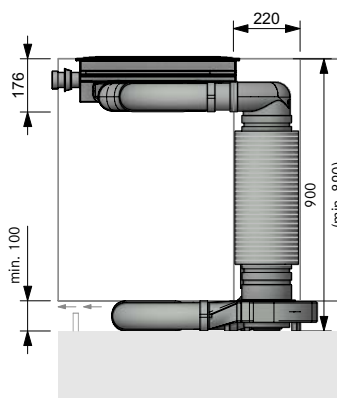

Installation may only be carried out in accordance with the applicable standards, regulations and laws.

Model plans

BORA Professional 3.0

see more model plans at <https://partner.bora.com>

PKAS3 – exhaust air model for kitchen units

MP_6407 with air flow towards the back

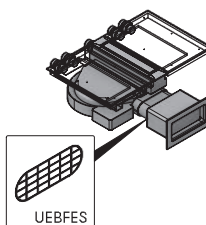
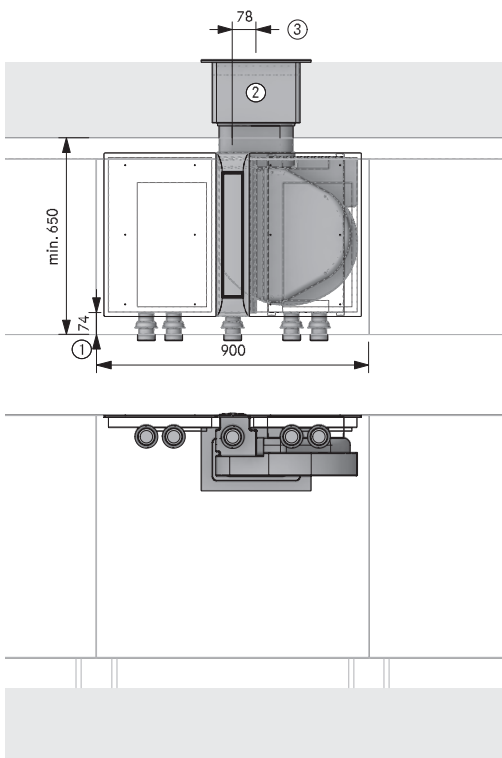

Planning instructions

- ① At least 74 mm from front edge to cut-out
- ② Wall opening 310 x 155 mm
71 mm from bottom edge of opening to centre of duct. Must expel air in a straight line regardless of the weather conditions
- ③ In the case of ducting ≤ 900 mm with no bend between the fan and wall sleeve, the UEBFES/UEBRES is required

BORA product

- 1 PKAS3 Pro cooktop extractor system with integrated fan

BORA Ecotube product

- 1 EFV/1 duct connection, shallow
- 1 UEBF/1 3box wall sleeve
- 1 UEBFES/1 3box wall sleeve safety guard
- 1 EF750/1 shallow duct 750 mm

Sealing material is included in the scope of delivery in the case of moulded parts with a socket design

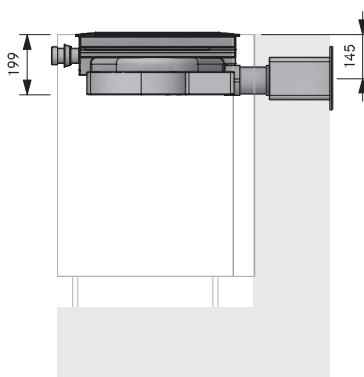

PKAS3 – exhaust air model for kitchen units

MP_6116 with airflow towards the left in the plinth

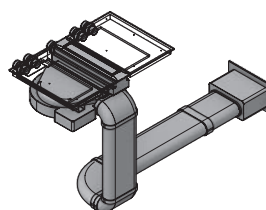
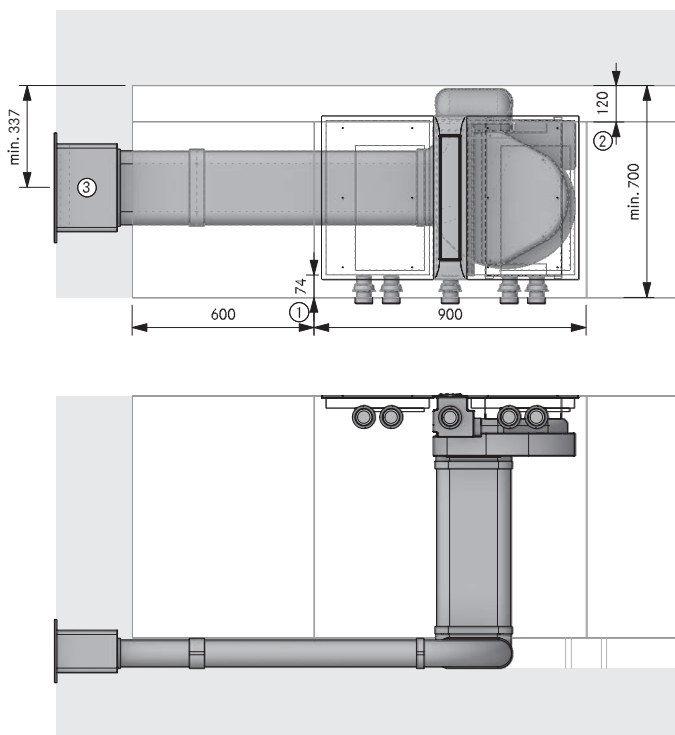

Planning instructions

- ① At least 74 mm from front edge to cut-out
- ② Space requirements for technology
- ③ Wall opening 310 x 155 mm
71 mm from bottom edge of opening to centre of duct. Must expel air in a straight line regardless of the weather conditions

BORA product

- 1 PKAS3 Pro cooktop extractor system with integrated fan

BORA Ecotube product

- 1 EFBH90/1 90° bend, shallow horizontal
- 2 EFBV90/1 90° bend, shallow vertical
- 1 EFV/1 duct connection, shallow
- 1 UEBF/1 3box wall sleeve
- 3 EF750/1 shallow duct 750 mm

Sealing material is included in the scope of delivery in the case of moulded parts with a socket design

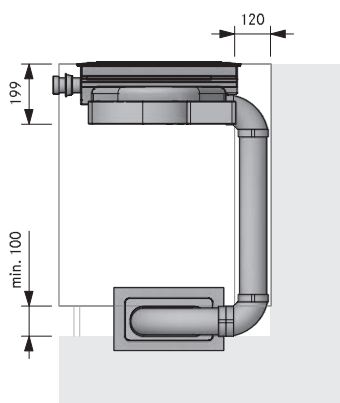

PKAS3 – exhaust air model for kitchen units

MP_6316 with airflow towards the right in the basement

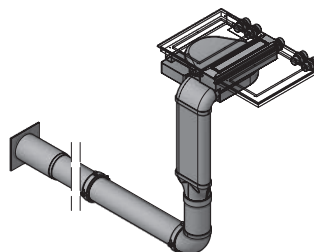
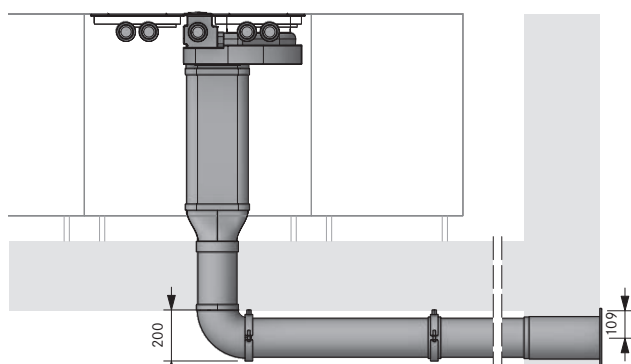
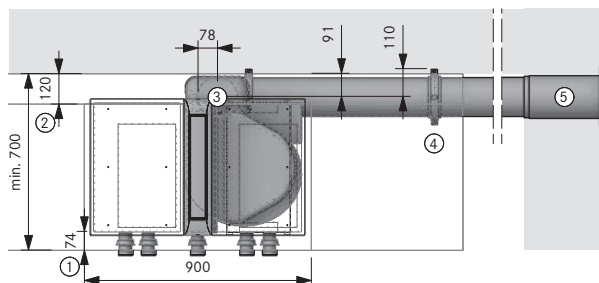

Planning instructions

- ① At least 74 mm from front edge to cut-out
- ② Space requirements for technology
- ③ Core bore hole at least Ø 180 mm
- ④ One mounting bracket set per Ecotube product with moulded coupling
- ⑤ Core bore hole at least Ø 180 mm
Must expel air in a straight line regardless of the weather conditions

BORA product

- 1 PKAS3 Pro cooktop extractor system with integrated fan

BORA Ecotube product

- 1 EFBV90/1 90° bend, shallow vertical
- 1 EFRG/1 transition, shallow round straight
- 1 UEBR/1 3box wall sleeve, round
- 1 ERB90/1 90° bend, round
- 1 ERMS/1 installation set, round
- 1 EF750/1 shallow duct 750 mm
- 1 ER750/1 round duct 750 mm

BORA Ecotube product according to requirements

- ERV/1 duct connection, round
- ERMS/1 installation set, round
- ER750/1 round duct 750 mm

Sealing material is included in the scope of delivery in the case of moulded parts with a socket design

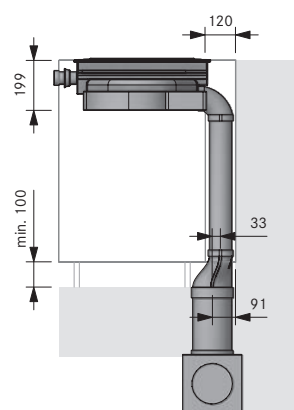

PKAS3 – exhaust air model for kitchen peninsulas

MP_6212 with airflow towards the right in floor installation

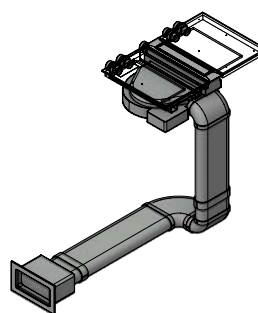
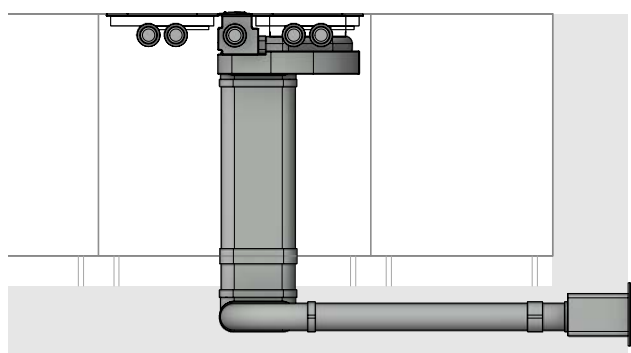
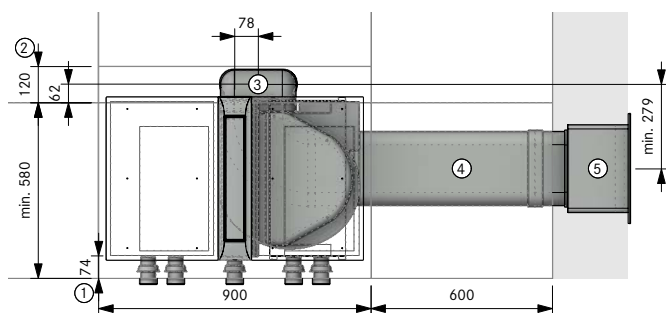

Planning instructions

- ① At least 74 mm from front edge to cut-out
- ② Space requirements for technology
- ③ Ecotube connection point
- ④ Fitted in floor installation according to DIN 18560-2 (fully integrated in the levelling layer). If the structure deviates from DIN 18560-2, reinforced screed must be provided for
- ⑤ Wall opening 310 x 155 mm
71 mm from bottom edge of opening to centre of duct. Must expel air in a straight line regardless of the weather conditions

BORA product

- 1 PKAS3 Pro cooktop extractor system with integrated fan

BORA Ecotube product

- 1 EFBH90/1 90° bend, shallow horizontal
- 2 EFBV90/1 90° bend, shallow vertical
- 1 EFV/1 duct connection, shallow
- 1 UEBF/1 3box wall sleeve
- 2 EF750/1 shallow duct 750 mm
- 2 EFS750/1 shallow duct with partition 750 mm

Sealing material is included in the scope of delivery in the case of moulded parts with a socket design

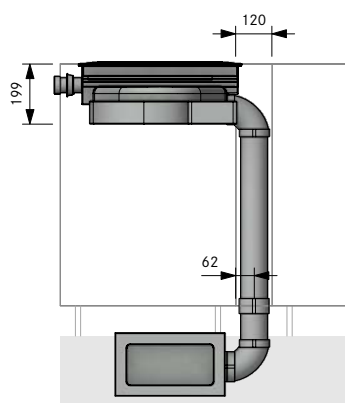

Model plans

BORA Professional 3.0

see more model plans at <https://partner.bora.com>

PKAS3 – recirculation model for kitchen islands

MP_6108 with ULBF air cleaning box in plinth

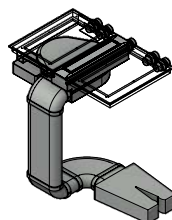
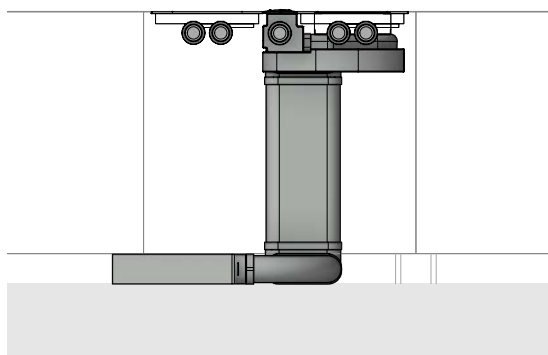
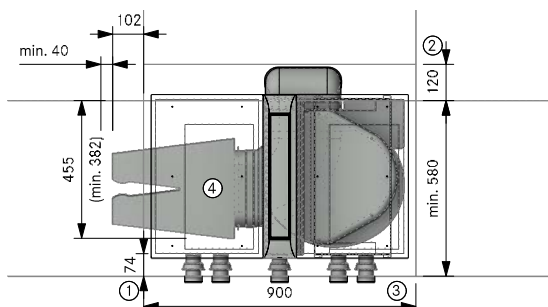

Planning instructions

- ① At least 74 mm from front edge to cut-out
- ② Space requirements for technology
- ③ Unobstructed return flow aperture at least 500 cm² per air cleaning box (at least 1000 cm² in the case of gas cooktops)
- ④ The air cleaning box must be accessible. Optimum filter performance thanks to the 500 mm shallow duct in front of the filter

BORA product

- 1 PKAS3 Pro Cooktop extractor system with integrated fan
- 1 ULBF Air cleaning box, flexible

BORA Ecotube product

- 1 EFBH90/1 90° bend, shallow horizontal
- 2 EFBV90/1 90° bend, shallow vertical
- 1 EF750/1 shallow duct 750 mm

Sealing material is included in the scope of delivery in the case of moulded parts with a socket design

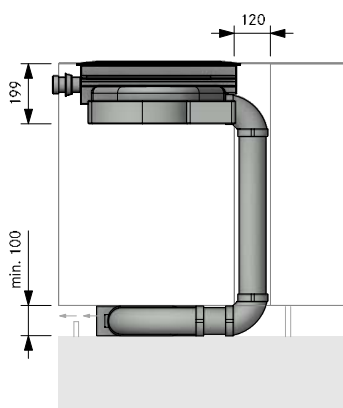

PKAS3 – recirculation model for kitchen islands

MP_6159 with ULB3 air cleaning box, hanging down

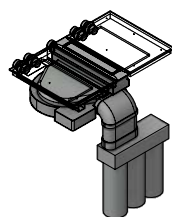
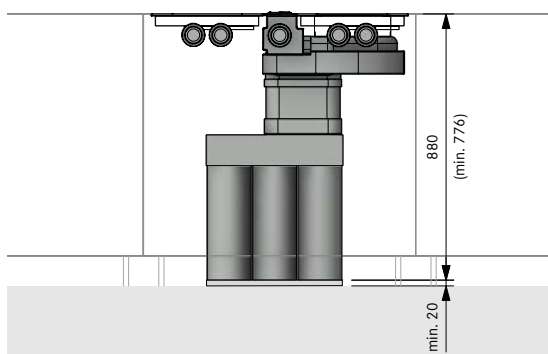
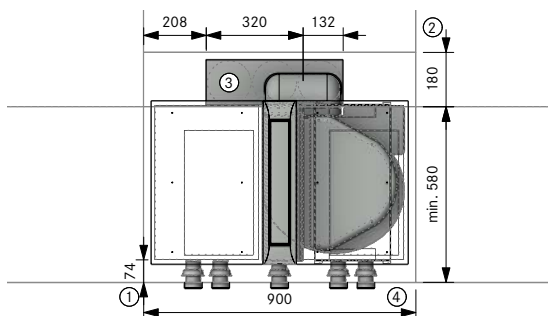

Planning instructions

- ① At least 74 mm from front edge to cut-out
- ② Space requirements for technology
- ③ The air cleaning box must be accessible to be able to replace filter cartridges and fine filters. Recommended space requirement (WxD) 800 x 180 mm or unobstructed 500 cm² free outflow area
- ④ Unobstructed return flow aperture at least 500 cm² per air cleaning box (at least 1000 cm² in the case of gas cooktops)

BORA product

- 1 PKAS3 Pro Cooktop extractor system with integrated fan
- 1 ULB3X air cleaning box 3

BORA Ecotube product

- 1 EFBV90/1 90° bend, shallow vertical
- 1 EFV/1 duct connection, shallow
- 1 EF750/1 shallow duct 750 mm

Sealing material is included in the scope of delivery in the case of moulded parts with a socket design

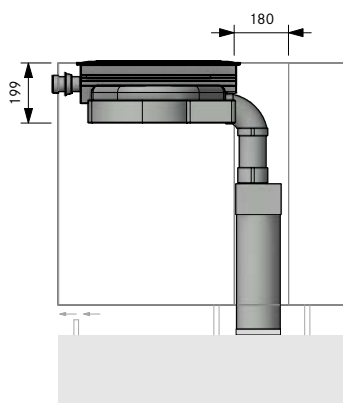

PKAS3 – recirculation model for kitchen islands

MP_6425 with ULB3X air cleaning box, standing to the side

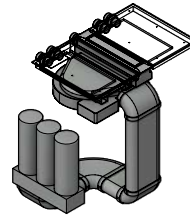
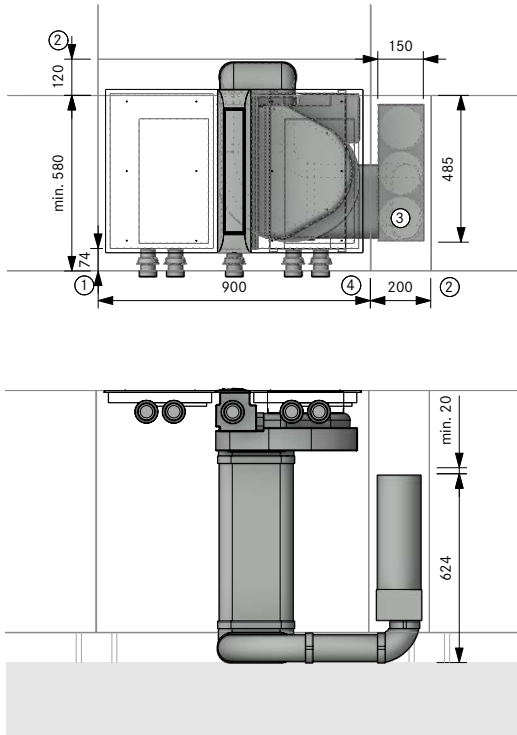

Planning instructions

- ① At least 74 mm from front edge to cut-out
- ② Space requirements for technology
- ③ The air cleaning box must be accessible to be able to replace filter cartridges and fine filters. Recommended space requirement (WxD) 800 x 180 mm or unobstructed 500 cm² free outflow area
- ④ Unobstructed return flow aperture at least 500 cm² per air cleaning box (at least 1000 cm² in the case of gas cooktops)

BORA product

- 1 PKAS3 Pro cooktop extractor system with integrated fan
- 1 ULB3X air cleaning box 3

BORA Ecotube product

- 3 EFBV90/1 90° bend, shallow vertical
- 1 EFBH90/1 90° bend, shallow horizontal
- 2 EF750/1 shallow duct 750 mm

Sealing material is included in the scope of delivery in the case of moulded parts with a socket design

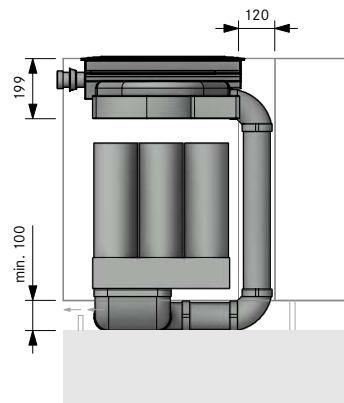

PKAS3 – double recirculation model for kitchen islands

MP_6134 with ULB3X air cleaning box, hanging

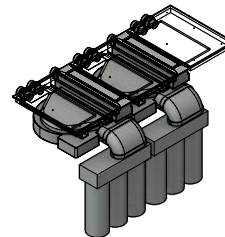
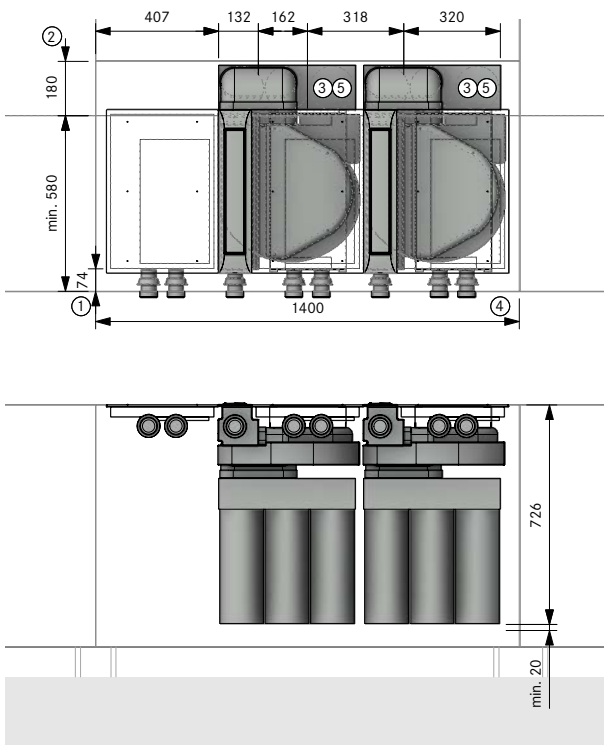

Planning instructions

- ① At least 74 mm from front edge to cut-out
- ② Space requirements for technology
- ③ The air cleaning box must be accessible to be able to replace filter cartridges and fine filters. Recommended space requirement (WxD) 800 x 180 mm or unobstructed 500 cm² free outflow area
- ④ Unobstructed return flow aperture at least 500 cm² per air cleaning box (at least 1000 cm² in the case of gas cooktops)
- ⑤ Ensure that the structure is stable when fitting ULB3X in a hanging position (min. load-bearing capacity 5,1 kg)

BORA product

- 2 PKAS3 Pro cooktop extractor system with integrated fan
- 2 ULB3X air cleaning box 3

BORA Ecotube product

- 2 EFBV90/1 90° bend, shallow vertical
- 2 EFV/1 duct connection, shallow
- 1 EF750/1 shallow duct 750 mm

Sealing material is included in the scope of delivery in the case of moulded parts with a socket design

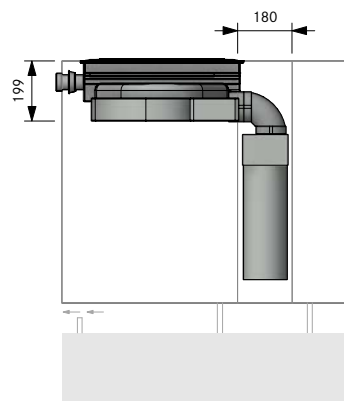

BORA Accessories Highlights

BORA PROFESSIONAL 3.0 ACCESSORIES



PKA 1VK

BORA Pro cover flap

PKA 1VKAB

BORA Pro cover flap All Black



PKA 1FW

BORA Pro filter tray



PKA 1FF

BORA Pro stainless steel grease filter

- Optimal grease removal
- matching accessories
- Complete BORA system



PKR 3

BORA Pro knob ring

PKR 3AB

BORA Pro knob ring All Black



HIW 1

BORA induction wok pan

- Induction possible
- Multi-layer material with special alloy
- Handle made of high-quality stainless steel



UGS

BORA glass ceramic scraper

- Easy removal of dirt and incrustations
- Suitable for all BORA glass ceramic cooktops
- matching accessories



PTTS 1

BORA Tepan spatula

- Suitable for flipping food and cleaning
- Suitable for BORA Tepan stainless steel grills

BORA UNIVERSAL ARTICLE ACCESSORIES



USTF

BORA socket type F



USTFAB

BORA All Black socket type F

- Connectivity for small electrical kitchen appliances
- Integrated childproofing feature
- Suitable for DE, ES, IT, AT, LU, PT, RU, BR, SE, NL



USTE

BORA socket type E



USTEAB

BORA socket type E All Black

- Connectivity for small electrical kitchen appliances
- Integrated childproofing feature
- Suitable for FR, PL, BE, CZ, SK



USTJ

BORA socket type J



USTJAB

BORA socket type J All Black

- Connectivity for small electrical kitchen appliances
- Suitable for CH, LI
- Spacing ring in the scope of delivery



USTG

BORA socket type G



USTGAB

BORA socket type G All Black

- Connectivity for small electrical kitchen appliances
- Suitable for UK, AE, SG
- Spacing ring in the scope of delivery



USTL

BORA socket type L



USTLAB

BORA socket type L All Black

- Connectivity for small electrical kitchen appliances
- Suitable for IT, SM
- Spacing ring in the scope of delivery

BORA GAS-NOZZLE SETS

NATURAL GAS

| item number | Ø SR burner/normal burner | Ø R burner/high-power burner | Countries |
|-------------|---------------------------|------------------------------|--|
| PKGDS2020 | 104 | 125 | AT, BE, CH, CY, CZ, DE, DK, EE, ES, FI, FR, GB, GR, HR, IE, IS, IT, LT, LU, LV, MT, NO, PL, PT, RO, SE, SI, SK, TR |
| PKGDS2525 | 104 | 131 | NL |
| PKGDS2013 | 115 | 149 | RU |
| PKGDS2025 | 100 | 119 | HU |
| PKGDS2520 | 110 | 131 | optional DE |
| PKGDS2010 | 122 | 155 | AUS, NZ |

LIQUID GAS

| item number | Ø SR burner/normal burner | Ø R burner/high-power burner | Countries |
|---------------------------------|---------------------------|------------------------------|--|
| PKGDS3028 | 69 | 85 | BE, CH, CY, CZ, DK, EE, ES, FI, FR, GB, GR, HR, HU, IE, IT, LT, NL, NO, PL, PT, RO, SE, SI, SK, TR |
| PKGDS3050 | 62 | 78 | AT, CH, DE, GR, SK |
| additional nozzle sets for PKG3 | | | |
| PKGDS3130 | 75 | 92 | AUS, NZ, CZ, FI, NL |
| PKGDS3150 | 65 | 80 | AT, CH, CZ, DE, NL, SK |

D

BORA Lüftungstechnik GmbH
Rosenheimer Straße 33
D-83064 Raubling, Germany
T +49 (0) 80 35 90 72 40
F +49 (0) 80 35 90 72 49
info@bora.com

A

BORA Vertriebs GmbH & Co KG
Innstraße 1
A-6342 Niederndorf, Austria
T +43 (0) 53 73 62 25 00
F +43 (0) 53736 22 50 90
mail@bora.com

INT

BORA Holding GmbH
Innstraße 1
A-6342 Niederndorf, Austria
T +43 (0) 53 73 62 25 00
F +43 (0) 53736 22 50 90
mail@bora.com